

# 3/16 Hex Female Standoff

Jameco Part# 133656

Jameco Electronics

1-800-831-4242

Hex Code Table		
✓	FCXXXX	Length (L)
	FC2051	1/8
	FC2052	3/16
	FC2053	1/4
	FC2054	5/16
	FC2055	3/8
	FC2056	7/16
	FC2057	1/2
	FC2058	9/16
	FC2059	5/8
	FC2060	11/16
	<b>FC2061</b>	<b>3/4</b>
	FC2062	13/16
	FC2063	7/8
	FC2064	15/16
	FC2065	1
	FC2066	1-1/16
	FC2067	1-1/8
	FC2068	1-3/16
	FC2069	1-1/4
	FC2070	1-5/16
	FC2071	1-3/8
	FC2072	1-7/16
	FC2073	1-1/2
	FC2074	1-9/16
	FC2075	1-5/8
	FC2076	1-11/16
	FC2077	1-3/4
	FC2078	1-13/16
	FC2079	1-7/8
	FC2080	1-15/16
	FC2081	2
	FC2082	2-1/16
	FC2083	2-1/8
	FC2084	2-3/16
	FC2085	2-1/4
	FC2086	2-5/16
	FC2087	2-3/8
	FC2088	2-7/16
	FC2089	2-1/2
	FC2090	2-9/16
	FC2091	2-5/8
	FC2092	2-11/16
	FC2093	2-3/4
	FC2094	2-13/16
	FC2095	2-7/8
	FC2096	2-15/16
	FC2097	3

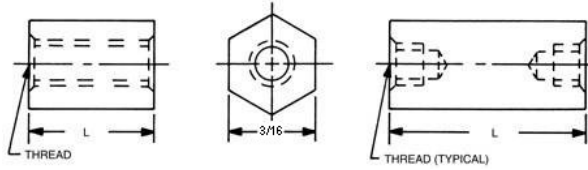

Create a part number:

Length	Thread	Material	Finish
FCXXXX	XXX	XX	XX
_____ - _____ - _____ - _____			

Thread				
✓	Thread Code (XXX)	Tapped Thru		Longer Parts
		A, B, S	SS	Blind Tap Depth
	256	3/4	5/8	3/16
	<b>440</b>	<b>1</b>	3/4	1/4

Aluminum (A), Brass (B), Steel (S), Stainless Steel (SS)

Material	
✓	Material Code (XX)
A	<b>Aluminum</b>
B	Brass
S	Steel
SS	Stainless Steel
N	Nylon

**Tolerances**  
**Unless otherwise Specified**  
 .xxx +/- .005  
 .xx +/- .010  
 Angular +/- 1 Degree  
 Linear +/- .005  
**Break all sharp edges**

✓		Compatible Finish
A, B, S, SS	0 - Plain	
B, S	5 - Nickel Plate (QQ-N-290)	
A	6 - Iridite #14 Gold (MIL-C-5541E)	
A	7 - Iridite Clear (MIL-C-5541E)	
A	9 - Alodine 1200	
B, S	12 - Zinc Clear (ASTM-B-633)	
B, S	16 - Electro Tin (MIL-T-10727 TYPE 1)	
SS	20 - Passivation (MIL-F-14072D)	
A	22 - Clear Anodize (MIL-A-8625-TYPE2) (Sulphuric) Hot Water Seal (Clear)	
A	24 - Black Anodize (MIL-A-8625)	
B, S, SS	26 - Black Oxide	
B, S	28 - Zinc Yellow (ASTM-B-633)	

Jameco Electronics

1-800-831-4242