

3/16 Hex Female Standoff

Jameco Part# 139185

Jameco Electronics

1-800-831-4242

| Hex Code Table | | |
|----------------|---------------|------------|
| ✓ | FCXXXX | Length (L) |
| | FC2051 | 1/8 |
| | FC2052 | 3/16 |
| | FC2053 | 1/4 |
| | FC2054 | 5/16 |
| | FC2055 | 3/8 |
| | FC2056 | 7/16 |
| | FC2057 | 1/2 |
| | FC2058 | 9/16 |
| | FC2059 | 5/8 |
| | FC2060 | 11/16 |
| | FC2061 | 3/4 |
| | FC2062 | 13/16 |
| | FC2063 | 7/8 |
| | FC2064 | 15/16 |
| | FC2065 | 1 |
| | FC2066 | 1-1/16 |
| | FC2067 | 1-1/8 |
| | FC2068 | 1-3/16 |
| | FC2069 | 1-1/4 |
| | FC2070 | 1-5/16 |
| | FC2071 | 1-3/8 |
| | FC2072 | 1-7/16 |
| | FC2073 | 1-1/2 |
| | FC2074 | 1-9/16 |
| | FC2075 | 1-5/8 |
| | FC2076 | 1-11/16 |
| | FC2077 | 1-3/4 |
| | FC2078 | 1-13/16 |
| | FC2079 | 1-7/8 |
| | FC2080 | 1-15/16 |
| | FC2081 | 2 |
| | FC2082 | 2-1/16 |
| | FC2083 | 2-1/8 |
| | FC2084 | 2-3/16 |
| | FC2085 | 2-1/4 |
| | FC2086 | 2-5/16 |
| | FC2087 | 2-3/8 |
| | FC2088 | 2-7/16 |
| | FC2089 | 2-1/2 |
| | FC2090 | 2-9/16 |
| | FC2091 | 2-5/8 |
| | FC2092 | 2-11/16 |
| | FC2093 | 2-3/4 |
| | FC2094 | 2-13/16 |
| | FC2095 | 2-7/8 |
| | FC2096 | 2-15/16 |
| | FC2097 | 3 |

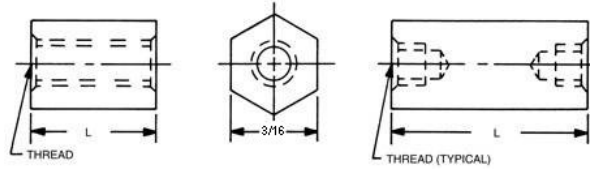

Create a part number:

| Length | Thread | Material | Finish |
|-------------------------------|--------|----------|--------|
| FCXXXX | XXX | XX | XX |
| _____ - _____ - _____ - _____ | | | |

| Thread | | | | |
|--------|-------------------|-------------|-----|-----------------|
| ✓ | Thread Code (XXX) | Tapped Thru | | Longer Parts |
| | | A, B, S | SS | Blind Tap Depth |
| | 256 | 3/4 | 5/8 | 3/16 |
| | 440 | 1 | 3/4 | 1/4 |

Aluminum (A), Brass (B), Steel (S), Stainless Steel (SS)

| Material | |
|----------|--------------------|
| ✓ | Material Code (XX) |
| A | Aluminum |
| B | Brass |
| S | Steel |
| SS | Stainless Steel |
| N | Nylon |

Tolerances Unless otherwise Specified
 .xxx +/- .005
 .xx +/- .010
 Angular +/- 1 Degree
 Linear +/- .005
Break all sharp edges

| ✓ Compatible Finish | |
|---------------------|--|
| A, B, S, SS | 0 - Plain |
| B, S | 5 - Nickel Plate (QQ-N-290) |
| A | 6 - Iridite #14 Gold (MIL-C-5541E) |
| A | 7 - Iridite Clear (MIL-C-5541E) |
| A | 9 - Alodine 1200 |
| B, S | 12 - Zinc Clear (ASTM-B-633) |
| B, S | 16 - Electro Tin (MIL-T-10727 TYPE 1) |
| SS | 20 - Passivation (MIL-F-14072D) |
| A | 22 - Clear Anodize (MIL-A-8625-TYPE2) (Sulphuric) Hot Water Seal (Clear) |
| A | 24 - Black Anodize (MIL-A-8625) |
| B, S, SS | 26 - Black Oxide |
| B, S | 28 - Zinc Yellow (ASTM-B-633) |

Jameco Electronics

1-800-831-4242