

1/4 Hex Male-Female Standoff

Jameco Electronics

1-800-831-4242

| Hex Length Table | |
|------------------|------------|
| FCXXXX | Length (L) |
| FC4530 | 1/4 |
| FC4531 | 5/16 |
| FC4532 | 3/8 |
| FC4533 | 7/16 |
| FC4534 | 1/2 |
| FC4535 | 9/16 |
| FC4536 | 5/8 |
| FC4537 | 11/16 |
| FC4538 | 3/4 |
| FC4539 | 13/16 |
| FC4540 | 7/8 |
| FC4541 | 15/16 |
| FC4542 | 1 |
| FC4543 | 1-1/16 |
| FC4544 | 1-1/8 |
| FC4545 | 1-3/16 |
| FC4546 | 1-1/4 |
| FC4547 | 1-5/16 |
| FC4548 | 1-3/8 |
| FC4549 | 1-7/16 |
| FC4550 | 1-1/2 |
| FC4551 | 1-9/16 |
| FC4552 | 1-5/8 |
| FC4553 | 1-11/16 |
| FC4554 | 1-3/4 |
| FC4555 | 1-13/16 |
| FC4556 | 1-7/8 |
| FC4557 | 1-15/16 |
| FC4558 | 2 |
| FC4559 | 2-1/8 |
| FC4560 | 2-1/4 |
| FC4561 | 2-3/8 |
| FC4562 | 2-1/2 |
| FC4563 | 2-5/8 |
| FC4564 | 2-3/4 |
| FC4565 | 2-7/8 |
| FC4566 | 3 |
| FC4567 | 3-1/4 |
| FC4568 | 3-1/2 |
| FC4569 | 3-3/4 |
| FC4570 | 4 |

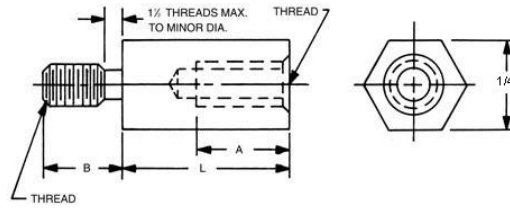

Create a part number:

| Length | Thread | Material | Finish |
|-------------------------------|--------|----------|--------|
| FCXXXX | XXX | XX | XX |
| _____ - _____ - _____ - _____ | | | |

| Thread | | | |
|--|------------|-------------|--|
| Short lengths, 'A' tapped to maximum depth | | | |
| Thread Code (XXX) | Depth (A) | Length (B) | |
| 256 | 3/16 | 5/32 | |
| 440 | 1/4 | 3/16 | |
| 632 | 3/8 | 1/4 | |
| 832 | 7/16 | 3/8 | |

| Material | |
|--------------------|-----------------|
| Material Code (XX) | |
| A | Aluminum |
| B | Brass |
| S | Steel |
| SS | Stainless Steel |
| N | Nylon |

Tolerances Unless otherwise Specified
 .xxx +/- .005
 .xx +/- .010
 Angular +/- 1 Degree
 Linear +/- .005
Break all sharp edges

| Compatible Finish | |
|-------------------|--|
| A, B, S, SS | 0 - Plain |
| B, S | 5 - Nickel Plate (QQ-N-290) |
| A | 6 - Iridite #14 Gold (MIL-C-5541E) |
| A | 7 - Iridite Clear (MIL-C-5541E) |
| A | 9 - Alodine 1200 |
| B, S | 12 - Zinc Clear (ASTM-B-633) |
| B, S | 16 - Electro Tin (MIL-T-10727 TYPE 1) |
| SS | 20 - Passivation (MIL-F-14072D) |
| A | 22 - Clear Anodize (MIL-A-8625-TYPE2) (Sulphuric) Hot Water Seal (Clear) |
| A | 24 - Black Anodize (MIL-A-8625) |
| B, S, SS | 26 - Black Oxide |
| B, S | 28 - Zinc Yellow (ASTM-B-633) |

Jameco Electronics

1-800-831-4242