

ARRANGEMENT OF CONTACTS

A9002-3P	A9002-4P	A9002-5P	A9002-6P	A9002-7P	A9002-8P

SPECIFICATIONS	
Contact resistance	30M ΩMax.
Dielectric strength	250V AC/1 Minute
Insulation resistance	50M ΩMin. at 250V DC
Rating	100V AC 1A Max.; 12V DC 2A Max.
Insertion force	4.5Kg Max.
Withdrawal force	0.9Kg ~ 3Kg

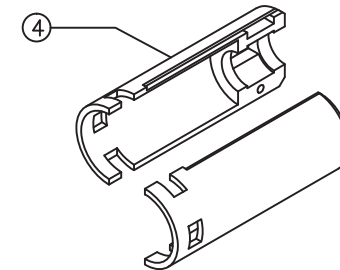
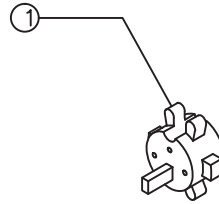
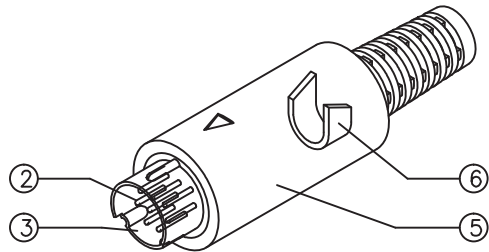
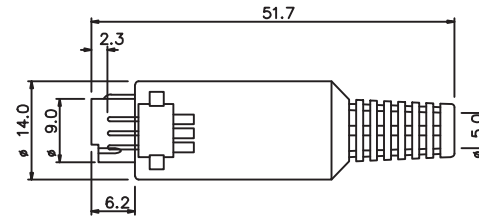
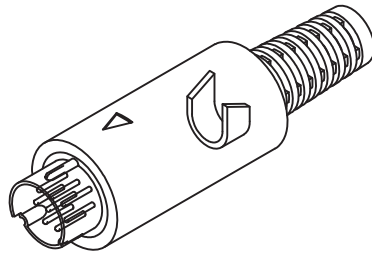

6	CLIP RING	1	BSR-H (0.8t)	NICKEL	3-5U*
5	MAIN BODY	1	EVA [UE633]		
4	PLASTIC LINING	1	ABS [777D]		HB
3	METAL COVER	1	BSR-H (0.4t) [C2680R]	NICKEL	3-5U*
2	CONTACT TERMINAL	6	BSR-H (0.59D) [R-35]	SILVER PLATED	3-5U*
1	PLASTIC CORE	1	PBT [D202G15]		UL94

P/N	PART NAME	Q'TY	MATERIAL	PLATING	REMARKS
DRAWN	KIDD			UNIT	mm
CHK'D		APP'D		SCALE	2:1
				TOLERANCE	.x ±0.20 .xx ±0.10 .xxx ±0.05 .xxxx ±0.03 ANGULA ±1°

GOLDSUN ELECTRONICS CO., LTD.

JAMECO NO.	142262	GOLDSUN NO.	A9002-6P
Description	MINI DIN MALE PLUG 6 PIN WITH STRAIN RELIEF		Rev. 1
UNIT:	SCALE:	SHEET 1 OF 1	CAS No: ERN No:
mm			