

Distributed by:

JAMECO[®]
ELECTRONICS

www.Jameco.com ♦ 1-800-831-4242

The content and copyrights of the attached
material are the property of its owner.

Jameco Part Number 155380

Date	Rev.	Description

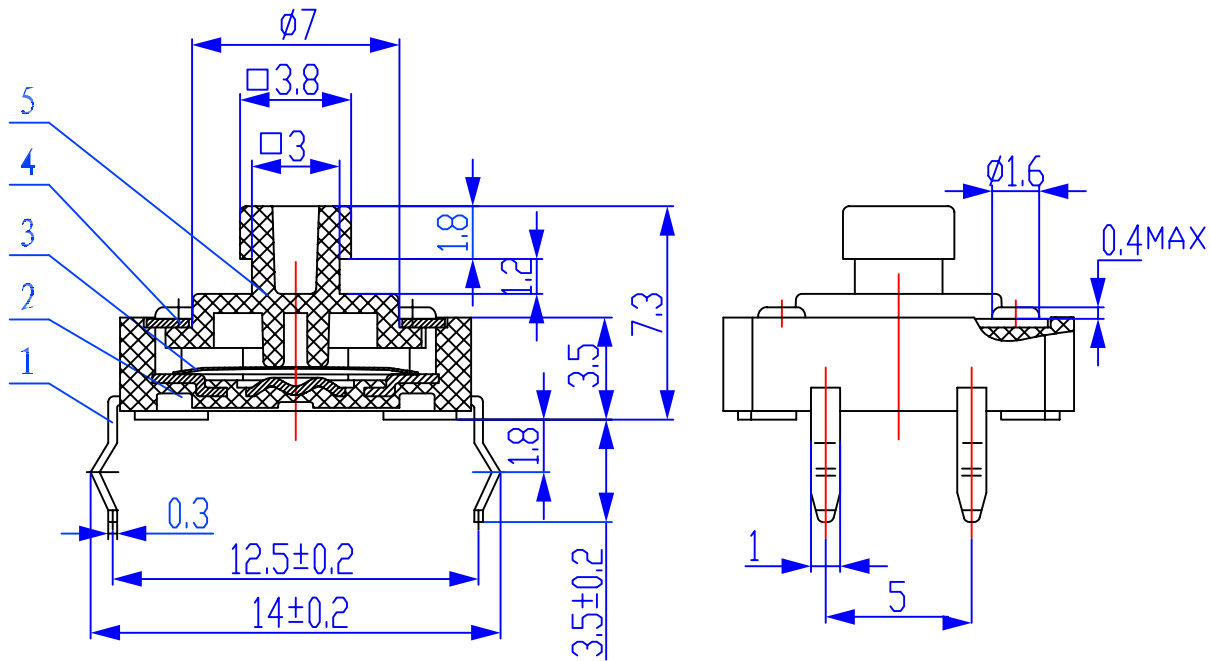

Circuit Diagram

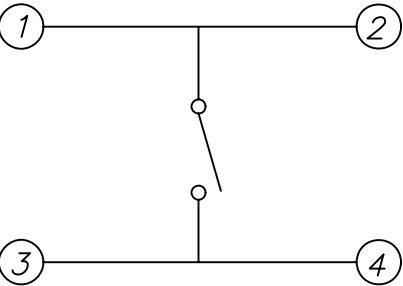

SPECIFICATIONS:

- 1. Rating :DC 12V 50mA
- 2. Travel :0.3±0.15mm
- 3. Contact Resistance :100mΩ Max
- 4. Life:100,000 Cycles Min.
- 5. General Tolerance:±0.2mm.

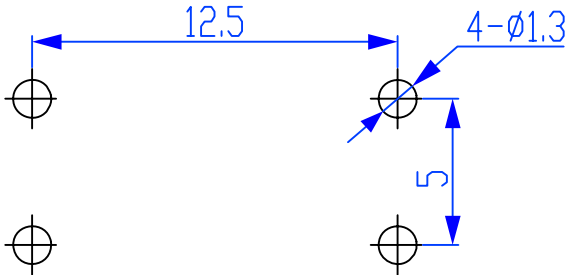
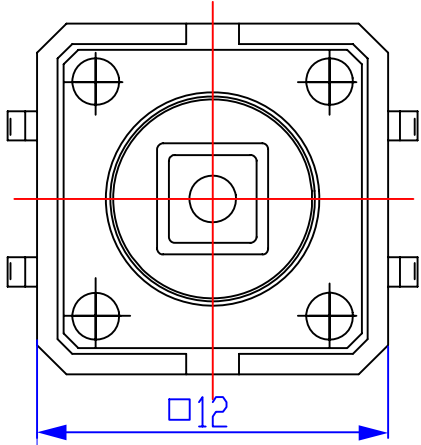

TYPE	1	2	3
Operating Force	130±30gf	160±30gf	250±30gf

DCC. NO.
A4 DRAWING NO.

MATERIAL		GOLDSUN ELECTRONICS CO., LTD.	
DRAWN: Kiki Chen		JAMECO NO. 155380	GOLDSUN NO. KRS-1273B-R
VERIFY PEOPLE: Wendy Chen, Fanny Du		Description PUSH BUTTON SWITCH 4P SPST	
UNIT: mm	SCALE:	SHEET 1 OF 1	CAS No: ERN No:
		Rev. 1	