

Distributed by:

JAMECO[®]
ELECTRONICS

www.Jameco.com ♦ 1-800-831-4242

The content and copyrights of the attached
material are the property of its owner.

Jameco Part Number 161307

Date	Rev.	Description

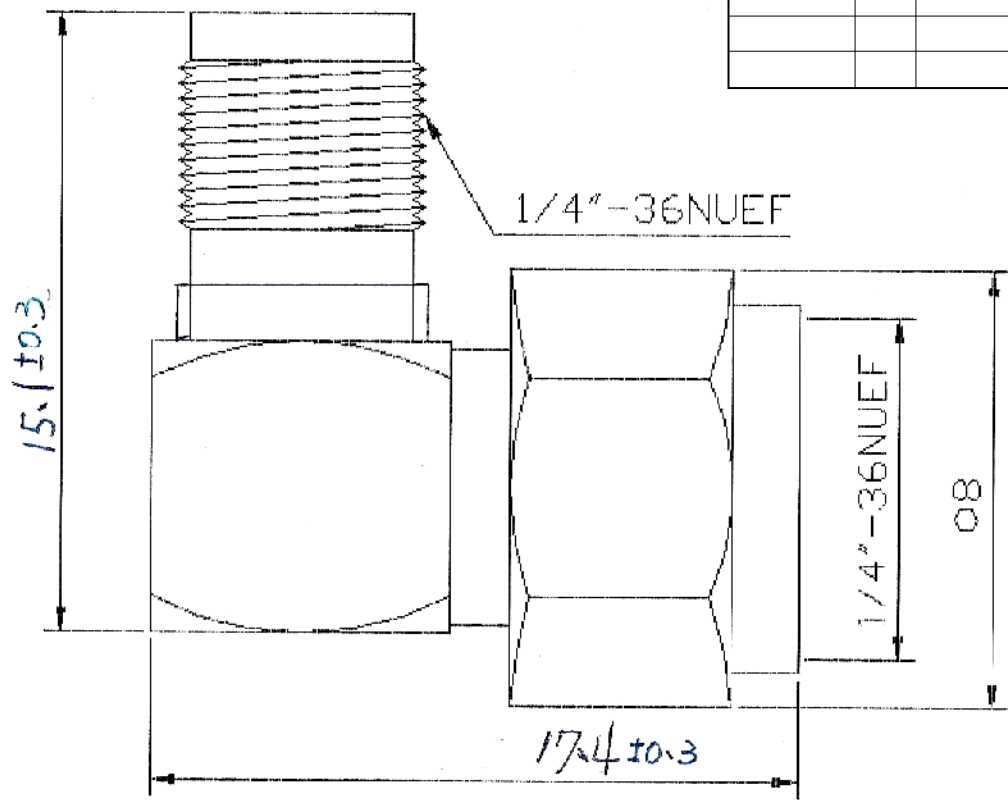

BODY	BRASS	GOLD
PIN	BRASS	GOLD
INSULATOR	TEFLON	WHITE
GASKET	RUBBER	RED

DCC. NO.
A4 DRAWING NO.

MATERIAL		GOLDSUN ELECTRONICS CO., LTD.	
DRAWN: Kiki Chen		JAMECO NO. 161307	GOLDSUN NO. WJ-7840-G
VERIFY PEOPLE: Ada Zheng, Ivy Lan		Description SMA MALE TO SMA FEMALE	
UNIT: mm	SCALE:	SHEET 1 OF 1	Rev. 1
		CAS No:	ERN No: