

Rev.	Description	Date
01	Update	04/24/2012

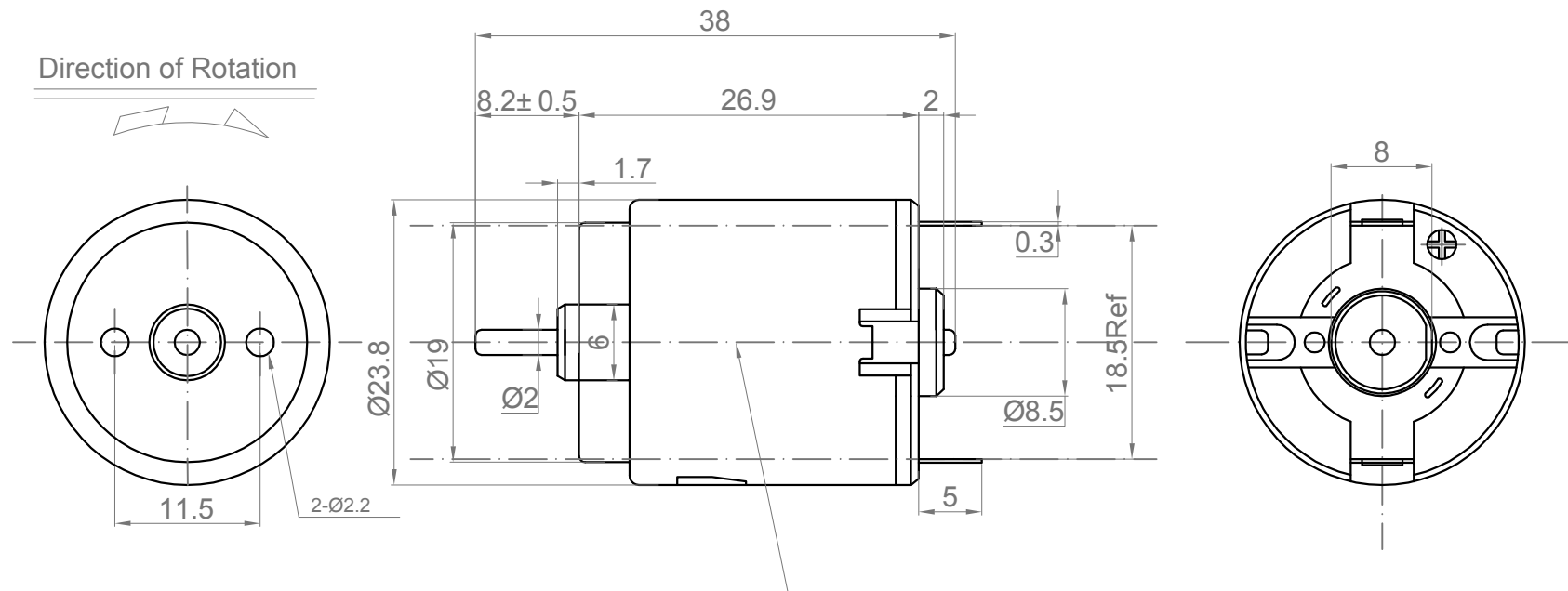

NO.	Item	Specification	NO.	Item	Specification
1	Rated Voltage	4.5 V DC	7	Rated Current	1.58A MAX
2	Operation Voltage Range	3-6 V/DC	8	Rated Speed	15000± 10% RPM
3	Rated Load	24 g.cm	9	Stall Torque	0.1225 g.cm
4	Direction of Rotation	CW	10	Stall Current	5.3A
5	No Load Current	0.38A MAX			
6	No Load Speed	18500± 10% RPM			

Drawn	Kim	04/24/2012	Unit: mm Sinotech	
Checked	Sara	04/24/2012		
Eng Appr.				
Mfg Appr.				
Q.A.				
P/N	211246		Size A4	Weight(Kg):
			Scale: 4:1	