

Rev	AWO #	Description	Date	Appr
-		RELEASED	6/29/10	

APPROVED: \_\_\_\_\_  
 DATE: \_\_\_\_\_ TITLE: \_\_\_\_\_

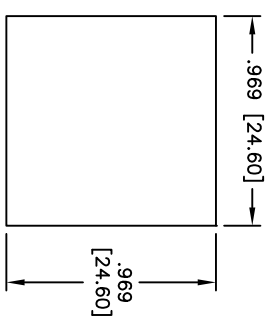
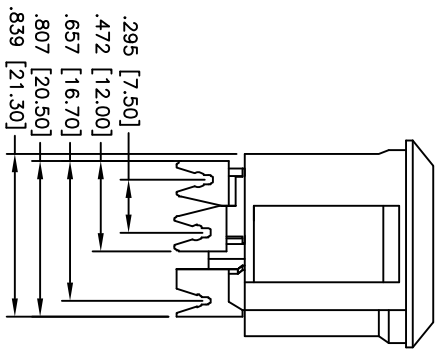
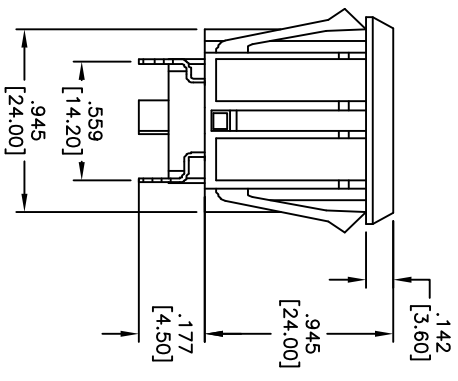
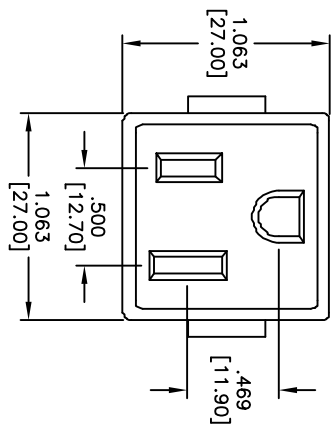

RECOMMENDED PANEL CUT-OUT  
 (THICKNESS 2.0mm Max)

**SPECIFICATIONS:**  
 Material: Insulator: PC, rated UL498 5-15R  
 Insulator color: Black  
 Contacts: Copper Alloy  
 Plating: Tin over Copper underplate overall  
 Electrical: Operating voltage: 125 VAC  
 Current rating: UL & CSA: 15 Amps max.  
 Environmental: Lead free, RoHS Compliant



UNLESS OTHERWISE SPECIFIED ALL DIMENSIONS ARE INCHES [MM]	
TOLERANCES EXCEPT AS NOTED	HOLDS
.X ± .10	ØX ± .10
.XX ± .020	ØXXX ± .015
.XXX ± .015	ØXXX ± .010
APPROVALS	DATE
DRAWN	DY
CHECKED	
APPROVED	

**ADAM TECH**  
 909 Rahway Avenue, Union, NJ 07083  
 Phone: 908-687-5000 Fax: 908-687-5710  
**NEMA RECEPTACLE**

SIZE	PART NO.	REV.
X	NEMA-5-2-A	-
REF: S00061T	SCALE: NTS	SHEET 1 OF 1

6 5 4 3 2 1