

Distributed by:

JAMECO[®]
ELECTRONICS

www.Jameco.com ♦ 1-800-831-4242

The content and copyrights of the attached
material are the property of its owner.

Jameco Part Number 21910

Date	Rev.	Description

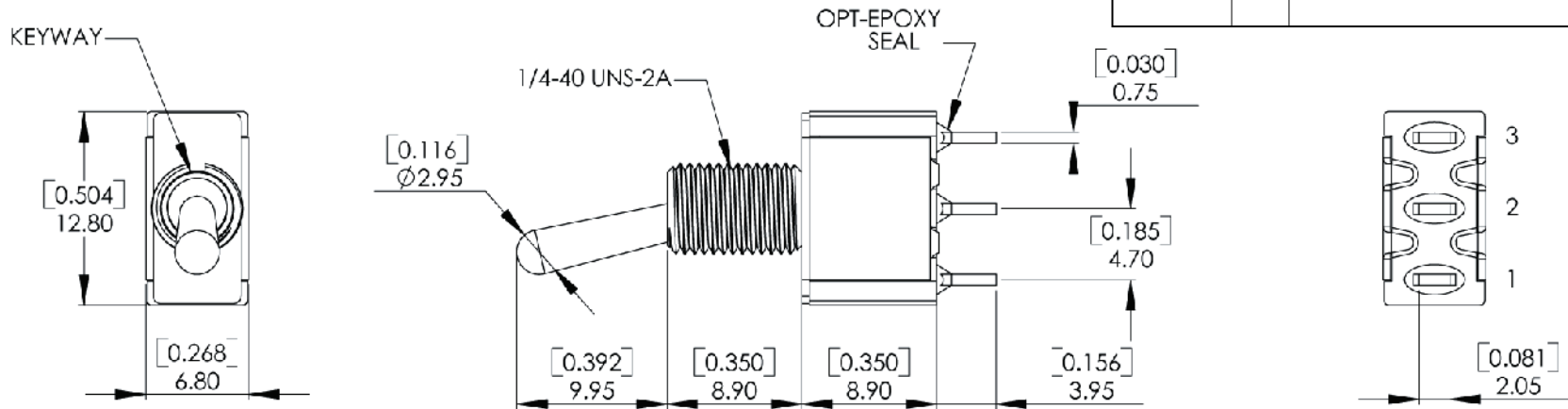

MATERIALS:

CASE : Diallyl phthalate (DAP)(UL-94V-0).
 ACTUATOR : Brass, chrome plated.
 BUSHING : Brass, nickel plated.
 HOUSING : Stainless steel.
 TERMINAL/CONTACT : Brass, with silver or gold plated.
 or gold over silver.
 SWITCH SUPPORT : Brass, tin plated.

SPECIFICATIONS:

CONTACT RATING : 5 AMPS @ 120 V AC or 28 V DC.
 2 AMPS @ 250 V AC or 0.4 AMPS @20 V AC or DC.
 ELECTRICAL LIFE : 50,000 make-and-break cycles at full load.
 CONTACT RESISTANCE : 10 mΩ max. initial @ 2-4 V DC.
 100 mA, for both silver and gold plated contacts.
 INSULATION RESISTANCE : 1,000 MΩ min.
 DIELECTRIC STRENGTH : 1,000 V RMS @ sea level.
 OPERATING TEMPERATURE : -30 °C to 130 °C

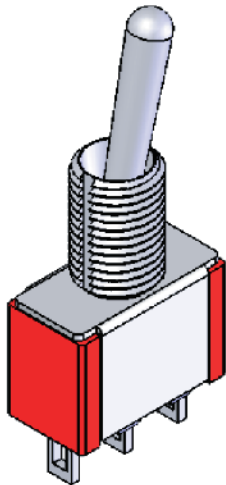

Schematic

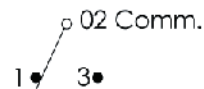

Model No.	Switching Position		
T101	ON	NONE	ON
T102	ON	NONE	(ON)
T103	ON	OFF	ON
T104	(ON)	OFF	(ON)
T105	ON	OFF	(ON)
Term Comm.	2-3	OPEN	2-1

DCC. NO.
A4 DRAWING NO.

MATERIAL	GOLDSUN ELECTRONICS CO., LTD.		
JAMECO NO.	21910	GOLDSUN NO.	
DRAWN: Kiki Chen	Description		Rev.
VERIFY PEOPLE: Ada Zheng , Ivy Lan	MINI TOGGLE SWITCH ON-ON		1
UNIT: mm	SCALE:	SHEET 1 OF 1	CAS No: ERN No: