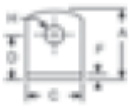

Fig. 1



Fig. 2



KEYSTONE Right Angle (L) Mounting Brackets

Jameco Part No.	Keystone Part No.	Fig.	Dimensions (in.)								Material	Plating	Pricing		
			A	B	C	D	E	F	G Dia.	H Dia.			1	10	100
Non-Threaded Clear Hole Universal Mounting Brackets															
2203135	613	2	.390	.453	.375	.234	.299	.032	.128	.147	Brass	Nickel	\$.39	\$.35	\$.29
2203151	4335	1	.562	.562	.500	.412	.411	.062	.120	.120	Steel	Nickel	.45	.39	.29
2203160	618	2	.628	.628	.375	.378	.378	.050	.169	.169	Brass	Nickel	.59	.49	.39
Threaded Hole Universal Mounting Brackets															
2203178	612	1	.343	.375	.250	.203	.250	.062	4-40	.130	Steel	Zinc	\$.29	\$.25	\$.19
1581530	621	1	.343	.375	.250	.203	.250	.062	4-40	4-40	Steel	Zinc	.35	.29	.25
2203186	616	1	.453	.312	.250	.265	.187	.047	4-40	.136	Brass	Tin	.49	.45	.35
2203194	634	1	.375	.375	.281	.218	.218	.032	6-32	.140	Brass	Nickel	.49	.45	.39
2203207	614	2	.420	.343	.312	.250	.197	.032	6-32	.144	Brass	Tin	.29	.25	.19
2203223	617	2	.578	.500	.500	.328	.299	.062	6-32	.165	Steel	Tin	.49	.45	.35

4-40 THREAD

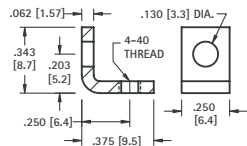

MATERIAL:
.062 (1.57) thick Steel,
Zinc Plate

CAT. NO. 612

4-40 THREAD

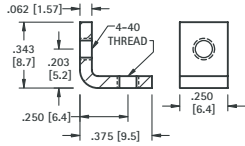

MATERIAL:
.062 (1.57) thick Steel,
Zinc Plate

CAT. NO. 621

4-40 THREAD

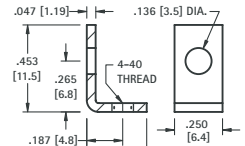

MATERIAL:
.047 (1.19) thick Brass,
Tin Plate

CAT. NO. 616

6-32 THREAD

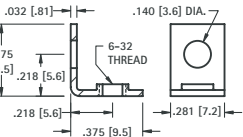

MATERIAL:
.032 (.81) thick Brass,
Nickel Plate

CAT. NO. 634

6-32 THREAD

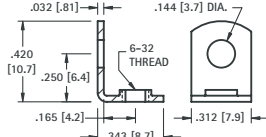

MATERIAL:
.032 (.81) thick Brass,
Tin Plate

CAT. NO. 614

6-32 THREAD

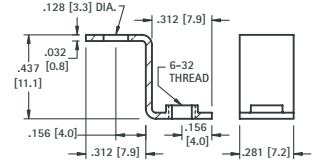

MATERIAL:
.032 (.81) thick Brass,
Tin Plate

CAT. NO. 630

6-32 THREAD

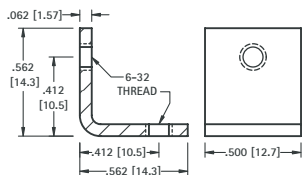

MATERIAL:
.062 (1.57) thick Steel,
Nickel Plate

CAT. NO. 4334

6-32 THREAD

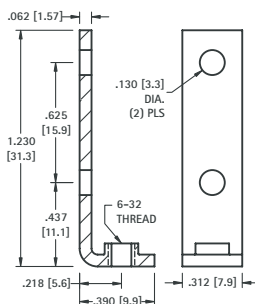

MATERIAL:
.062 (1.57) thick Steel,
Nickel Plate

CAT. NO. 708

6-32 THREAD

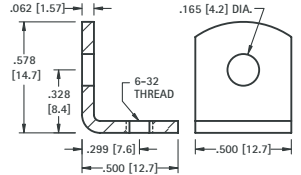

MATERIAL:
.062 (1.57) thick Steel,
Tin Plate

CAT. NO. 617

6-32 or 8-32 THREAD

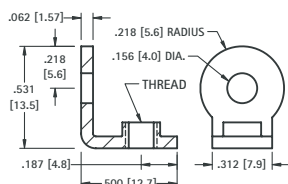

MATERIAL:
.062 (1.57) thick Brass,
Nickel Plate

CAT. NO.	THREAD
4332	6-32
4333	8-32

8-32 THREAD

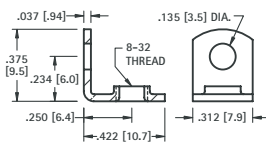

MATERIAL:
.037 (.94) thick Brass,
Tin Plate

CAT. NO. 611

8-32 THREAD

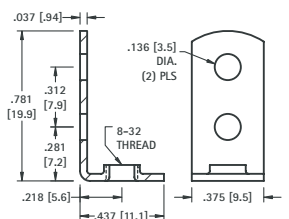

MATERIAL:
.037 (.94) thick Steel,
Tin Plate

CAT. NO. 631

UNIVERSAL CLEAR HOLE BRACKETS

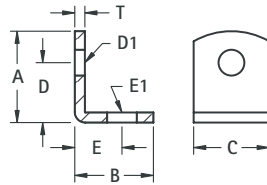
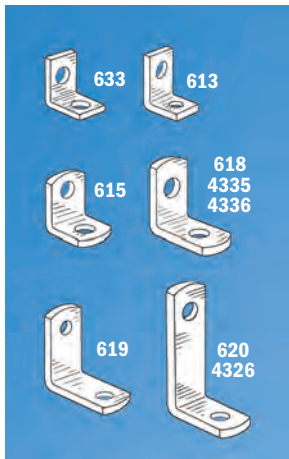

CAT. NO.	A	B	C	D	D HOLE DIAMETER	E	E HOLE DIAMETER	T	MATERIAL	FINISH
633	.375 (9.5)	.375 (9.5)	.281 (7.1)	.218 (5.5)	.140 (3.6)	.218 (5.5)	.140 (3.6)	.032 (.81)	Brass	Nickel
613	.390 (9.9)	.453 (11.5)	.375 (9.5)	.234 (5.9)	.147 (3.7)	.299 (7.6)	.128 (3.3)	.032 (.81)	Brass	Nickel
615	.420 (10.7)	.343 (8.7)	.281 (7.1)	.281 (7.1)	.144 (3.7)	.203 (5.2)	.128 (3.3)	.032 (.81)	Brass	Tin
4335	.562 (14.3)	.562 (14.3)	.500 (12.7)	.412 (10.5)	.120 (3.0)	.411 (10.4)	.120 (3.0)	.062 (1.57)	Steel	Nickel
4336	.562 (14.3)	.562 (14.3)	.500 (12.7)	.412 (10.5)	.144 (3.7)	.412 (10.5)	.144 (3.7)	.062 (1.57)	Steel	Nickel
618	.628 (16.0)	.628 (16.0)	.375 (9.5)	.378 (9.6)	.169 (4.3)	.378 (9.6)	.169 (4.3)	.050 (1.27)	Brass	Tin
619	.687 (17.4)	.687 (17.4)	.375 (9.5)	.500 (12.7)	.144 (3.7)	.500 (12.7)	.144 (3.7)	.032 (.81)	Steel	Tin
4326	1.013 (25.7)	.487 (12.4)	.312 (7.9)	.816 (20.7)	.140 (3.6)	.332 (8.4)	.140 (3.6)	.050 (1.27)	Steel	Nickel
620	1.156 (29.4)	.656 (16.7)	.375 (9.5)	.906 (23.0)	.169 (4.3)	.420 (10.7)	.169 (4.3)	.032 (.81)	Steel	Tin

BOARD BRACKETS

Originally designed for our line of standardized terminal boards; these brackets can also be used in other applications.

Choice of Steel or Aluminum

MATERIALS:

.062 (1.57) thick Steel, Nickel Plate
.062 (1.57) thick Aluminum

STEEL CAT. NO.	ALUMINUM CAT. NO.	W	L	S	For Use With Board No.'s (Refer to page 130)		
1556	622	.375 (9.5)	1.625 (41.3)	1.000 (25.4)	15032	15072	15092
1567	623	.375 (9.5)	2.125 (54.0)	1.500 (38.1)	15033	15073	15093
1568	624	.375 (9.5)	2.625 (66.7)	2.000 (50.8)	15034	15074	15094
1569	625	.375 (9.5)	3.125 (79.4)	2.500 (63.5)	15035	15075	15095
1570	626	.281 (7.1)	1.187 (30.1)	.750 (19.1)	15022	15024	15030
1571	627	.281 (7.1)	1.625 (41.3)	1.187 (30.1)	15036	15076	15096

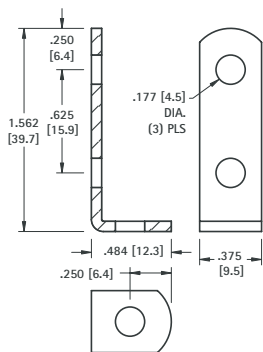
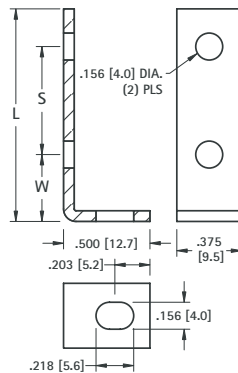

CAT. NO. 1564

MATERIAL:

.062 (1.57) thick Steel, Nickel Plate

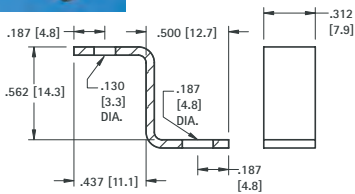

CAT. NO. 4325

MATERIAL:

.050 (1.27) thick Steel, Nickel Plate

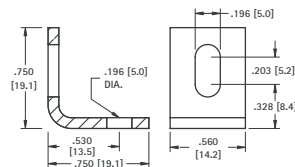

CAT. NO. 4337

MATERIAL:

.080 (2.03) thick Aluminum

THREADED PC MOUNT BRACKETS

- Snaps in for wave soldering
- Reduces assembly time
- Easily mount into predrilled or punched holes
- Stable no rock design



SNAP-IN PC MOUNT



For screw selection refer to pages 79 and 123

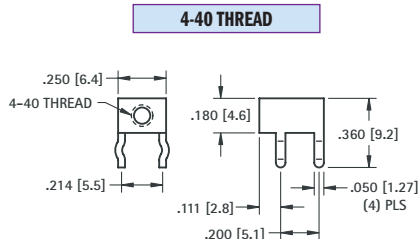

MATERIAL:

.032 (.81) thick Brass, Tin Plate

CAT. NO. 7774

Mounting Detail

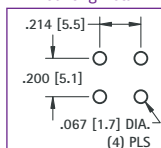

6-32 THREAD

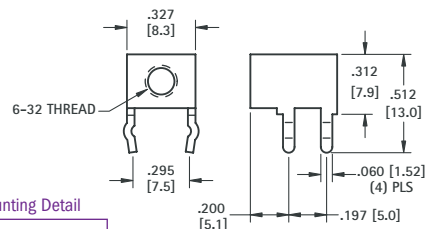

MATERIAL:

.032 (.81) thick Brass, Tin Plate

CAT. NO. 7779

Mounting Detail

