

Distributed by:

**JAMECO**<sup>®</sup>  
ELECTRONICS

**www.Jameco.com ♦ 1-800-831-4242**

The content and copyrights of the attached  
material are the property of its owner.

Jameco Part Number *752675*

THIS DRAWING IS UNPUBLISHED. RELEASED FOR PUBLICATION  
 © COPYRIGHT BY TYCO ELECTRONICS CORPORATION. ALL RIGHTS RESERVED.

LOC	DIST	REVISIONS					
GP	00	P	LTR	DESCRIPTION	DATE	DWN	APVD
		U		REVISED PER EC OS13-0493-03	03MAR04	BM	JG

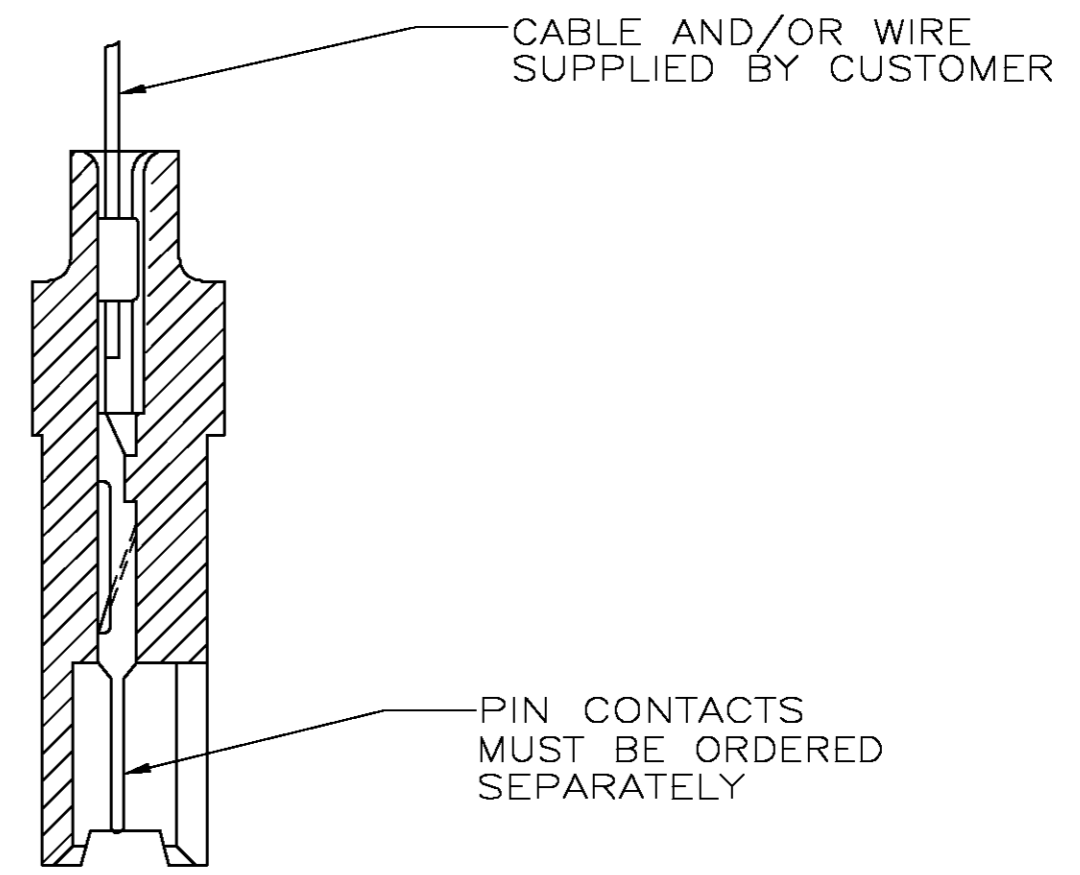
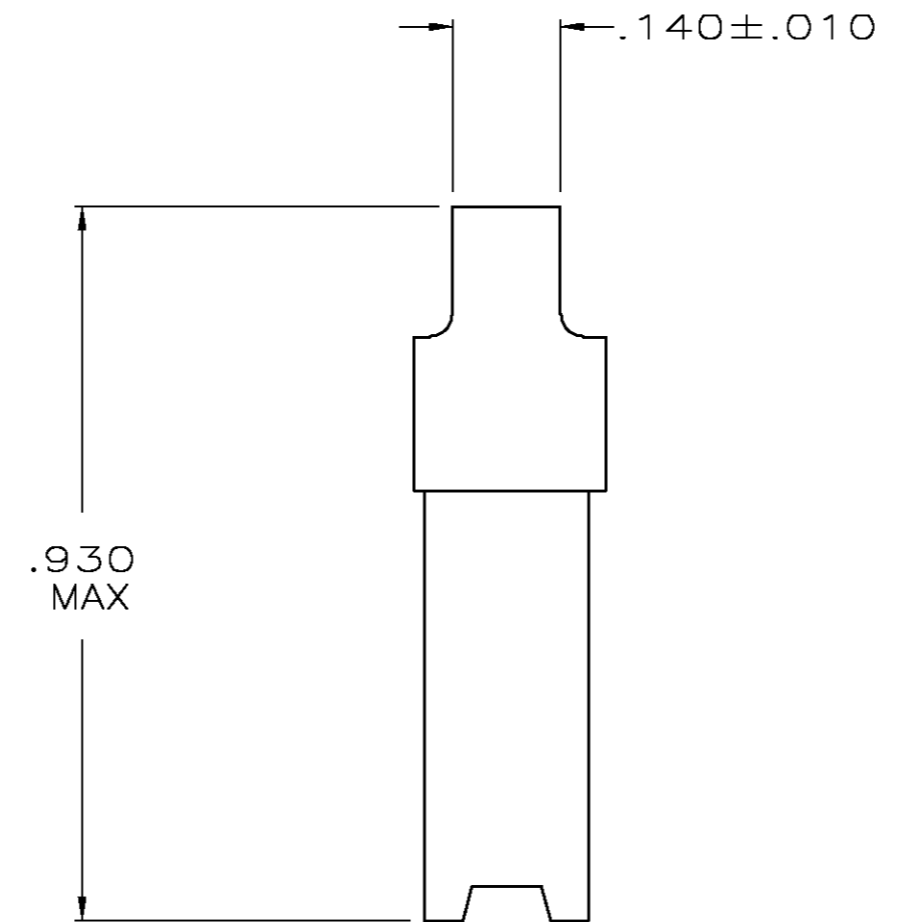
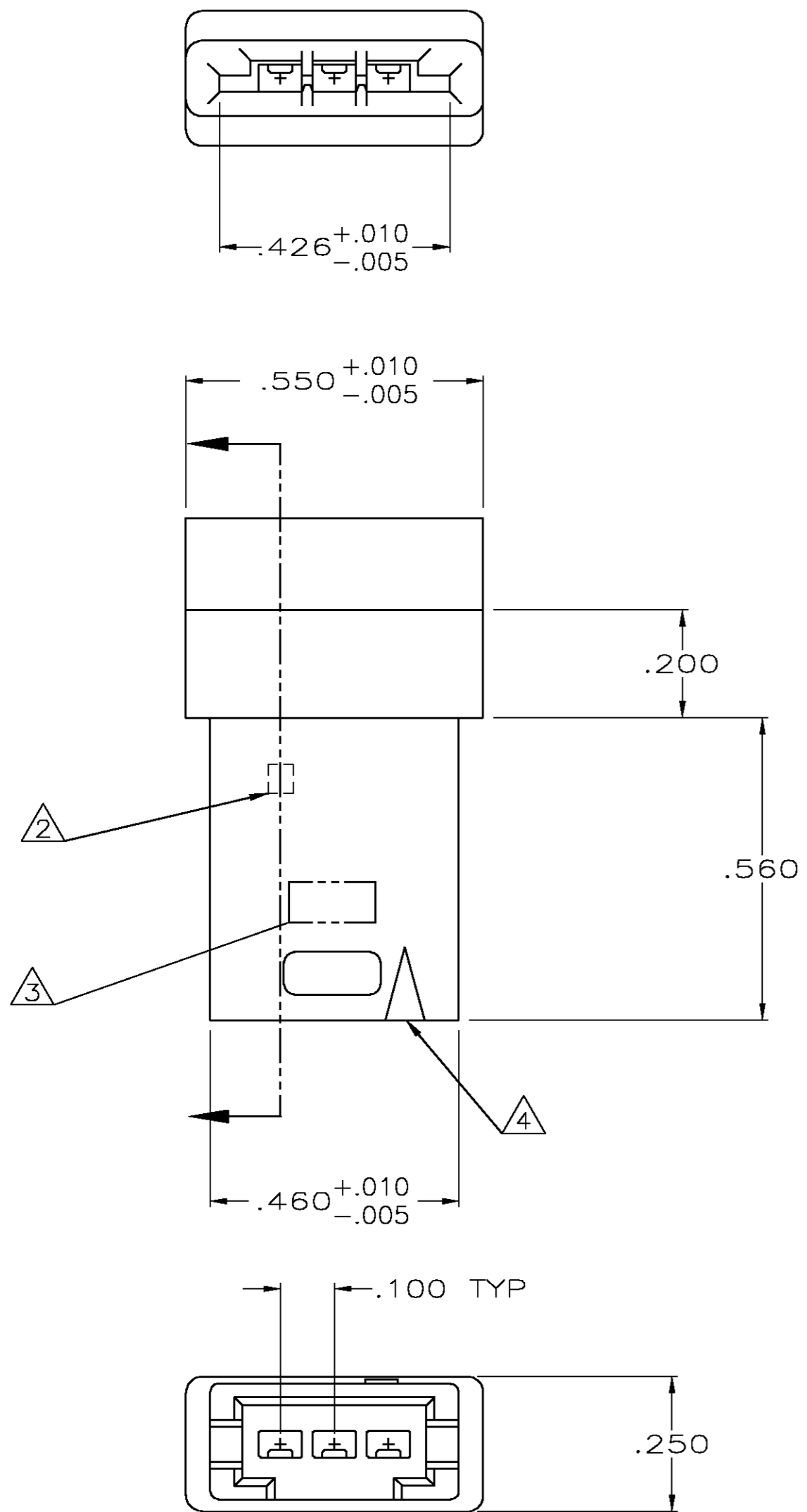

SECTION X-X  
 CRIMPED CONTACT SHOWN FOR REFERENCE ONLY

- HOUSING WILL ACCOMMODATE FLEXIBLE FLAT CONDUCTOR CABLE .050 WIDE CONDUCTORS ON .100 CENTERS AND/OR #32-22 AWG WIRE WITH INSULATION RANGE .025-.056 DIAMETER.
- CIRCUIT IDENT NO MOLDED AT FIRST AND THIRD POSITION.
- AMP TRADEMARK MOLDED IN THIS AREA.
- INDICATES FIRST POSITION.

THIS DRAWING IS A CONTROLLED DOCUMENT.		DWN B. MCMASTER 03MAR04	Tyco Electronics Corporation Harrisburg, Pa 17105-3608				
DIMENSIONS: mm [INCHES]		CHK S. BOLASH 03MAR04					
TOLERANCES UNLESS OTHERWISE SPECIFIED:		APVD M. WALMSLEY 03MAR04	NAME HOUSING, PIN, W/DETENT SLOTS, .100ϕ, FFC				
0 PLC ± - 1 PLC ± - 2 PLC ± - 3 PLC ± .005 4 PLC ± - ± - ANGLES ± - ± - FINISH -		PRODUCT SPEC 108-9024	SIZE A2	CAGE CODE 00779	DRAWING NO C=494032	RESTRICTED TO -	
MATERIAL THERMOPLASTIC GLASS FILLED COLOR: BLACK		APPLICATION SPEC 114-16015	CUSTOMER DRAWING		SCALE 4:1	SHEET 1 OF 1	REV U