

Distributed by:

JAMECO[®]
ELECTRONICS

www.Jameco.com ♦ 1-800-831-4242

The content and copyrights of the attached
material are the property of its owner.

Jameco Part Number 880386

FEATURES AND SPECIFICATIONS

Features and Benefits

- Sizes 2 to 18 circuits
- Provides left to right polarization when mated with 41695 or 43061 .156" crimp housing with the optional polarizing ribs
- Various pin lengths available
- Voided circuits available (contact Molex)
- Passive locking feature is used to maintain interconnection, ideal for high vibration applications
- End-to-end stackable

Reference Information

Product Specification: PS-08-50

Packaging: Bag

UL File No.: E29179

CSA File No.: LR19980

TUV File No.: R75108

Mates With: [2139](#), [2145](#), [3069](#), [6442](#), [7674](#), [7675](#),

[41695](#) and [41815](#)

Designed In: Inches

Electrical

Voltage: 250V

Current: 7.0A

Contact Resistance: 6mΩ max.

Dielectric Withstanding Voltage: 1500V

Insulation Resistance: 50K MΩ min.

Mechanical

Durability:

Tin—25 cycles max.

Gold—100 cycles max.

Physical

Housing: Polyester, UL 94V-0

Contact: Brass, 1.14mm (.045") pin

Plating: See Table

Operating Temperature: 0 to +75°C

molex® **3.96mm (.156") Pitch**
KK®

Solid Header

41791

Vertical
Friction Lock

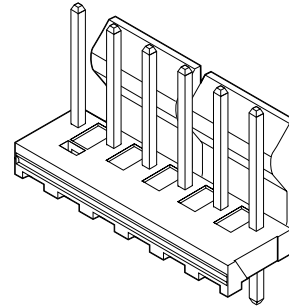

CATALOG DRAWING (FOR REFERENCE ONLY)

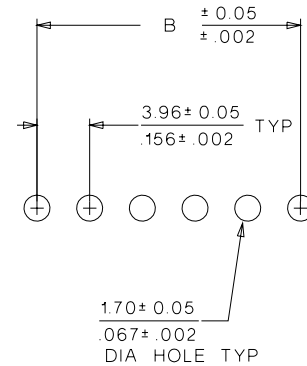
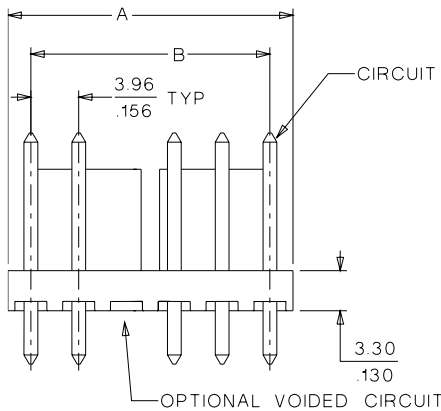
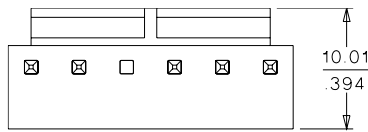

PCB LAYOUT: COMPONENT SIDE
RECOMMENDED PCB THICKNESS $\frac{1.67 \pm 0.18}{.062 \pm .007}$

ORDERING INFORMATION AND DIMENSIONS

| Circuits | Order No. | | | | Dimension | |
|----------|------------|------------------|------------------|--------------|---------------|---------------|
| | Tin | 15μ" Select Gold | 30μ" Select Gold | Overall Gold | A | B |
| 2 | 26-60-4020 | 41791-0832 | 41791-0849 | 26-61-4020 | 7.77 (.306) | 3.96 (.156) |
| 3 | 26-60-4030 | 41791-0833 | 41791-0850 | 26-61-4030 | 11.73 (.462) | 7.92 (.312) |
| 4 | 26-60-4040 | 41791-0834 | 41791-0851 | 26-61-4040 | 15.70 (.618) | 11.89 (.468) |
| 5 | 26-60-4050 | 41791-0835 | 41791-0852 | 26-61-4050 | 19.66 (.774) | 15.85 (.624) |
| 6 | 26-60-4060 | 41791-0836 | 41791-0853 | 26-61-4060 | 23.62 (.930) | 19.81 (.780) |
| 7 | 26-60-4070 | 41791-0837 | 41791-0854 | 26-61-4070 | 27.58 (1.086) | 23.77 (.936) |
| 8 | 26-60-4080 | 41791-0838 | 41791-0855 | 26-61-4080 | 31.55 (1.242) | 27.74 (1.092) |
| 9 | 26-60-4090 | 41791-0839 | 41791-0856 | 26-61-4090 | 35.51 (1.398) | 31.70 (1.248) |
| 10 | 26-60-4100 | 41791-0840 | 41791-0857 | 26-61-4100 | 39.47 (1.554) | 35.66 (1.404) |
| 11 | 26-60-4110 | 41791-0841 | 41791-0858 | 26-61-4110 | 43.43 (1.710) | 39.62 (1.560) |
| 12 | 26-60-4120 | 41791-0842 | 41791-0859 | 26-61-4120 | 47.40 (1.866) | 43.59 (1.716) |
| 13 | 26-60-4130 | 41791-0843 | 41791-0860 | 26-61-4130 | 51.36 (2.022) | 47.55 (1.872) |
| 14 | 26-60-4140 | 41791-0844 | 41791-0861 | 26-61-4140 | 55.32 (2.178) | 51.51 (2.028) |
| 15 | 26-60-4150 | 41791-0845 | 41791-0862 | 26-61-4150 | 59.28 (2.334) | 55.47 (2.184) |
| 16 | 26-60-4160 | 41791-0846 | 41791-0863 | 26-61-4160 | 63.25 (2.490) | 59.44 (2.340) |
| 17 | 26-60-4170 | 41791-0847 | 41791-0864 | 26-61-4170 | 67.21 (2.646) | 63.40 (2.496) |
| 18 | 26-60-4180 | 41791-0848 | 41791-0865 | 26-61-4180 | 71.17 (2.802) | 67.36 (2.652) |

Circuit number designation is for ordering purposes only, check corresponding circuit designation on mating connector



PRODUCT SPECIFICATION

1.0 SCOPE

This Product Specification covers the 3.96 mm (.156 inch) centerline (pitch) 1.14mm (.045) square pin headers when mated with either printed circuit board (PCB) connectors or connectors terminated with 18 to 26 AWG wire using crimp technology.

2.0 PRODUCT DESCRIPTION

2.1 PRODUCT NAME AND SERIES NUMBERS

Crimp Terminals: 2478,2578,2878,2477,
Crimp Housings: 2139, 41695
PCB Connectors: 2145, 41815
Headers: 41771, 41772, 41791, 41792, 42471, 42472, 42491, 42492, 41661, 41662, 41671, 61672, 41681, 41682
Other products conforming to this specification are noted on the individual drawings.

2.2 DIMENSIONS, MATERIALS, PLATINGS AND MARKINGS

Terminal Material: Brass or Phos. Bronze (for Max performance use phos bronze material.)
Housing: Nylon or Polyester
Pins: Brass or Phos. Bronze
For more information on dimensions, materials, and plating see the individual drawings.

2.3 SAFETY AGENCY APPROVALS

UL File Number E29179
CSALR19980

3.0 APPLICABLE DOCUMENTS AND SPECIFICATIONS

None

4.0 RATINGS

4.1 VOLTAGE

250 Volts

4.2 CURRENT (Current is dependent on connector size, contact material, plating, ambient temperature, printed circuit board characteristics and related factors. Actual current rating is application dependent and should be evaluated for each application.)

a. For Crimp Terminals- and Applicable Wires

| Wire Awg | Amps (Max) With Brass | Amps (Max) With Phos Bronze | Wire Insulation Dia |
|----------|-----------------------|-----------------------------|-----------------------|
| 18 | 5.00 | 7.00 | See terminal drawings |
| 20 | 4.75 | 6.25 | See terminal drawings |
| 22 | 4.50 | 5.50 | See terminal drawings |
| 24 | 4.25 | 5.00 | See terminal drawings |
| 26 | 4.00 | 4.50 | See terminal drawings |

| | | | |
|--|--|---|--|
| REVISION: R | ECR/ECN INFORMATION: EC No: UCR2002-0299 DATE: 2001 / 09 / 18 | TITLE: PRODUCT SPECIFICATION .156 CENTER KK CONNECTORS | SHEET No. 1 of 5 |
| DOCUMENT NUMBER: PS-08-50 | CREATED / REVISED BY: SAMIEC | CHECKED BY: MUELLER | APPROVED BY: MARGULIS |



PRODUCT SPECIFICATION

4.2 CURRENT (cont)

b. For Printed Circuit Board Connectors

| Connector Style | Amps (Max) With Brass | Amps (Max) With Phos Bronze |
|-----------------|-----------------------|-----------------------------|
| Top Entry | 4.50 | 5.00 |
| Right Angle | 4.50 | 5.00 |
| Bottom Entry | 4.00 | 4.50 |

4.3 TEMPERATURE (ambient + 30°C temp rise)

| | Brass | Phos Bronze |
|---------------------------|-----------------|-----------------|
| Operating Temperature | 0°C to +50°C | 0°C to +75°C |
| Non Operating Temperature | -40°C to +105°C | -40°C to +105°C |

5.0 PERFORMANCE

5.1 ELECTRICAL REQUIREMENTS

| DESCRIPTION | TEST CONDITION | REQUIREMENT |
|--|---|--------------------------------------|
| Contact Resistance (Low Level) | Mate connectors: apply a maximum voltage of 20 mV and a current of 100 mA. | 10 milliohms MAXIMUM [initial] |
| Contact Resistance of Wire Termination (Low Level) | Terminate the applicable wire to the terminal and measure wire using a voltage of 20 mV and a current of 100 mA. | 2 milliohms MAXIMUM [initial] |
| Insulation Resistance | Unmate & unmount connectors: apply a voltage of 500 VDC between adjacent terminals and between terminals to ground. | 1000 Megohms MINIMUM |
| Dielectric Withstanding Voltage | Unmate connectors: apply a voltage of {two times the rated voltage plus 1000 volts} VAC for 1 minute between adjacent terminals and between terminals to ground. | No breakdown |
| Capacitance | Measure between adjacent terminals at 1 MHz. | 1.2 picofarads MAXIMUM |
| Temperature Rise (via Current Cycling) | Mate connectors: measure the temperature rise at the rated current after: 1) 96 hours (steady state) 2) 240 hours (45 minutes ON and 15 minutes OFF per hour) 3) 96 hours (steady state) | Temperature rise: +30°C MAXIMUM |

| | | | |
|-------------------------------------|---|--|---------------------------------|
| REVISION: R | ECR/ECN INFORMATION: EC No: UCR2002-0299 DATE: 2001 / 09 / 18 | TITLE: PRODUCT SPECIFICATION .156 CENTER KK CONNECTORS | SHEET No. 2 of 5 |
| DOCUMENT NUMBER: PS-08-50 | CREATED / REVISED BY: SAMIEC | CHECKED BY: MUELLER | APPROVED BY: MARGULIS |



PRODUCT SPECIFICATION

5.2 MECHANICAL REQUIREMENTS

| DESCRIPTION | TEST CONDITION | REQUIREMENT |
|---|---|--|
| Connector Mate and Unmate Forces | Per circuit when mated to an .045 Sq. pin. Mate and unmate connector (male to female) at a rate of 25 ± 6 mm ($1 \pm \frac{1}{4}$ inch) per minute. | 10.0 N (2.25 lbf) MAXIMUM insertion force & 3.7 N (0.84 lbf) MINIMUM withdrawal force |
| Terminal Insertion Force (into Housing) | Apply an axial insertion force on the terminal at a rate of 25 ± 6 mm ($1 \pm \frac{1}{4}$ inch). (Forces will change with platings and materials.) | 17.8 N (4.0 lbf) MAXIMUM insertion force |
| Terminal Retention Force (in Housing) | Axial pullout force on the terminal in the housing at a rate of 25 ± 6 mm ($1 \pm \frac{1}{4}$ inch) per minute. (Forces will change with platings and materials.) | 35.6 N (8.0 lbf) MINIMUM withdrawal force |
| Durability | Mate connectors up to 25 cycles at a maximum rate of 10 cycles per minute prior to Environmental Tests. | 10 milliohms MAXIMUM (change from initial) |
| Vibration (Random) | Mate connectors and vibrate per EIA 364-28, test condition VII. | 10 milliohms MAXIMUM (change from initial) & Discontinuity < 1 microsecond |
| Shock (Mechanical) | Mate connectors and shock at 50 g's with $\frac{1}{2}$ sine wave (11 milliseconds) shocks in the $\pm X, \pm Y, \pm Z$ axes (18 shocks total). | 10 milliohms MAXIMUM (change from initial]) & Discontinuity < 1 microsecond |
| Wire Pullout Force (Axial) | Apply an axial pullout force on the wire at a rate of 25 ± 6 mm ($1 \pm \frac{1}{4}$ inch). (For maximum performance use Molex application tooling with stranded tinned copper wire) | 18 awg = 89 N (20 lbf) 20 awg = 66 N (15 lbf) 22 awg = 53 N (12 lbf) 24 awg = 35 N (8 lbf) 26 awg = 22 N (5 lbf) |
| Normal Force | Apply a perpendicular force. | 7.34 N (748 grams) average |

| | | | |
|-------------------------------------|---|--|---------------------------------|
| REVISION: R | ECR/ECN INFORMATION: EC No: UCR2002-0299 DATE: 2001 / 09 / 18 | TITLE: PRODUCT SPECIFICATION .156 CENTER KK CONNECTORS | SHEET No. 3 of 5 |
| DOCUMENT NUMBER: PS-08-50 | CREATED / REVISED BY: SAMIEC | CHECKED BY: MUELLER | APPROVED BY: MARGULIS |



PRODUCT SPECIFICATION

5.3 ENVIRONMENTAL REQUIREMENTS

| DESCRIPTION | TEST CONDITION | REQUIREMENT | | | | | | | | | | |
|----------------------------|--|--|--------------------|-----------|----|---------|-----------|------------|----|---------|-----------|---|
| Shock (Thermal) | Mate connectors; expose to 5 cycles of: <table border="1"> <thead> <tr> <th>Temperature °C</th> <th>Duration (Minutes)</th> </tr> </thead> <tbody> <tr> <td>-40 +0/-3</td> <td>30</td> </tr> <tr> <td>+25 ±10</td> <td>5 MAXIMUM</td> </tr> <tr> <td>+105 +3/-0</td> <td>30</td> </tr> <tr> <td>+25 ±10</td> <td>5 MAXIMUM</td> </tr> </tbody> </table> | Temperature °C | Duration (Minutes) | -40 +0/-3 | 30 | +25 ±10 | 5 MAXIMUM | +105 +3/-0 | 30 | +25 ±10 | 5 MAXIMUM | 10 milliohms MAXIMUM (change from initial) & Visual: No Damage |
| Temperature °C | Duration (Minutes) | | | | | | | | | | | |
| -40 +0/-3 | 30 | | | | | | | | | | | |
| +25 ±10 | 5 MAXIMUM | | | | | | | | | | | |
| +105 +3/-0 | 30 | | | | | | | | | | | |
| +25 ±10 | 5 MAXIMUM | | | | | | | | | | | |
| Thermal Aging | Mate connectors; expose to: 96 hours at 105 ± 2°C | 10 milliohms MAXIMUM (change from initial]) & Visual: No Damage | | | | | | | | | | |
| Humidity (Steady State) | Mate connectors: expose to a temperature of 40 ± 2°C with a relative humidity of 90-95% for 96 hours. Note: Remove surface moisture and air dry for 1 hour prior to measurements. | 10 milliohms MAXIMUM (change from initial) & Dielectric Withstanding Voltage: No Breakdown at 500 VAC & Insulation Resistance: 1000 Megohms MINIMUM & Visual: No Damage | | | | | | | | | | |
| Humidity (Cyclic) | Mate connectors: cycle per EIA-364-31: 24 cycles at temperature 25 ± 3°C at 80 ± 5% relative humidity and 65 ± 3°C at 50 ± 5% relative humidity; dwell time of 1.0 hour; ramp time of 0.5 hours. {Note: Remove surface moisture and air dry for 1 hour prior to measurements.} | 10 milliohms MAXIMUM (change from initial) & Dielectric Withstanding Voltage: No Breakdown at 500 VAC & Insulation Resistance: 1000 Megohms MINIMUM & Visual: No Damage | | | | | | | | | | |
| Solderability | Per SMES-152 | Solder coverage: 95% MINIMUM (per SMES-152) | | | | | | | | | | |

| | | | |
|-------------------------------------|---|--|---------------------------------|
| REVISION: R | ECR/ECN INFORMATION: EC No: UCR2002-0299 DATE: 2001 / 09 / 18 | TITLE: PRODUCT SPECIFICATION .156 CENTER KK CONNECTORS | SHEET No. 4 of 5 |
| DOCUMENT NUMBER: PS-08-50 | CREATED / REVISED BY: SAMIEC | CHECKED BY: MUELLER | APPROVED BY: MARGULIS |



PRODUCT SPECIFICATION

5.3 ENVIRONMENTAL REQUIREMENTS

| DESCRIPTION | TEST CONDITION | REQUIREMENT |
|--|---|---|
| Solder Resistance | Dip connector terminal tails in solder: Solder Duration: 5 ± 0.5 seconds; Solder Temperature: 230 ± 5°C | Visual: No Damage to insulator material |
| Salt Spray | Mate connectors: Duration: 48 hours exposure; Atmosphere: salt spray from a 5% solution; Temperature: 35 +1/-2°C | 10 milliohms MAXIMUM (change from initial) & Visual: No Damage |
| Cold Resistance | Mate connectors: Duration: 96 hours; Temperature: -40 ± 3°C | 10 milliohms MAXIMUM (change from initial) & Visual: No Damage |
| Corrosive Atmosphere: Flowing Mixed Gas (FMG) | Mate connectors: Test per EIA-364-65, method 2A | 10 milliohms MAXIMUM (change from initial) & Visual: No Damage |

6.0 PACKAGING

Parts shall be packaged to protect against damage during handling, transit and storage.

7.0 GAGES AND FIXTURES

8.0 OTHER

| | | | |
|-------------------------------------|---|--|---------------------------------|
| REVISION: R | ECR/ECN INFORMATION: EC No: UCR2002-0299 DATE: 2001 / 09 / 18 | TITLE: PRODUCT SPECIFICATION .156 CENTER KK CONNECTORS | SHEET No. 5 of 5 |
| DOCUMENT NUMBER: PS-08-50 | CREATED / REVISED BY: SAMIEC | CHECKED BY: MUELLER | APPROVED BY: MARGULIS |

10 9 8 7 6 5 4 3 2 1

F

E

D

C

B

A

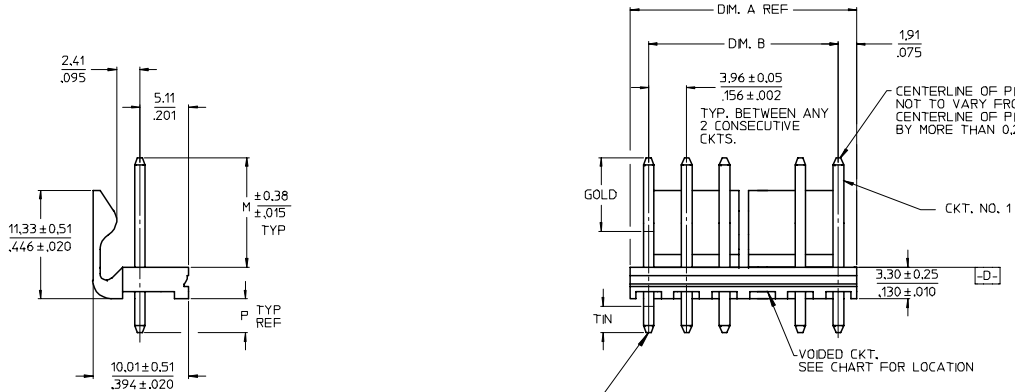

CENTERLINE OF PIN AT TP
NOT TO VARY FROM
CENTERLINE OF PIN AT DATUM -D-
BY MORE THAN 0.13/005 IN ANY DIRECTION.

| CKT | DM. A | DM. B |
|-----|----------------|--------------------------|
| 2 | 7.77 .306 | 3.96±0.05 .156±.002 |
| 3 | 11.73 .462 | 7.92±0.08 .312±.003 |
| 4 | 15.70 .618 | 11.89±0.08 .468±.003 |
| 5 | 19.66 .774 | 15.85±0.10 .624±.004 |
| 6 | 23.62 .930 | 19.81±0.10 .780±.004 |
| 7 | 27.58 1.086 | 23.77±0.10 .936±.004 |
| 8 | 31.55 1.242 | 27.74±0.13 1.092±.005 |
| 9 | 35.51 1.398 | 31.70±0.13 1.248±.005 |
| 10 | 39.47 1.554 | 35.66±0.13 1.404±.005 |
| 11 | 43.43 1.710 | 39.62±0.15 1.560±.006 |
| 12 | 47.40 1.866 | 43.59±0.15 1.716±.006 |
| 13 | 51.36 2.022 | 47.55±0.15 1.872±.006 |
| 14 | 55.32 2.178 | 51.51±0.18 2.028±.007 |
| 15 | 59.28 2.334 | 55.47±0.18 2.184±.007 |
| 16 | 63.25 2.490 | 59.44±0.18 2.340±.007 |
| 17 | 67.21 2.646 | 63.40±0.20 2.496±.008 |
| 18 | 71.17 2.802 | 67.36±0.20 2.652±.008 |

- NOTES:
- MATERIAL: HEADER-GLASS FILLED POLYESTER, 94V-0, MOLDED NATURAL (WHITE).
 - FINISH: (102-TIN) OVERALL TIN: 0.00508/0.000200 MIN OVER 0.00254/0.000100 MN COPPER.
(122-TIN) OVERALL TIN: 0.00381/0.000150 MN OVER 0.00076/0.000030 MN NICKEL.
(208-15 GOLD) SELECT GOLD: 0.00038/0.000015 MN, SELECT TIN: 0.00254/0.000100 MN, OVERALL NICKEL UNDERPLATE: 0.00127/0.000050 MN.
(228-30 GOLD) SELECT GOLD: 0.00076/0.000030 MN, SELECT TIN: 0.00254/0.000100 MN, OVERALL NICKEL UNDERPLATE: 0.00127/0.000050 MN.
(501-GOLD) OVERALL GOLD: 0.00051/0.000020 MN OVER 0.00076/0.000030 MN NICKEL.
 - THE PRIMARY SHIPPING CARTON WILL BE LABELED "COMPLIANT TO RoHS DIRECTIVE 2002/95/EC AND ELV ANNEX II OF DIRECTIVE 2000/53/EC". CARTONS WITHOUT THIS LABEL MAY CONTAIN PRODUCT WITH TIN-LEAD PLATING.
 - PRODUCT SPECIFICATION AND PROCESS PARAMETERS; SEE PS-08-50.
 - PACKAGING INFORMATION; SEE CHARTS.
 - SOLDERABILITY: PER SMES-152.
 - PIN PUSH-OUT FORCE: PRIOR TO SOLDERING, A 3 LB. MINIMUM FORCE IN EITHER DIRECTION.
 - PARTS ARE STACKABLE END TO END ON 3.96/.156 CENTERS.

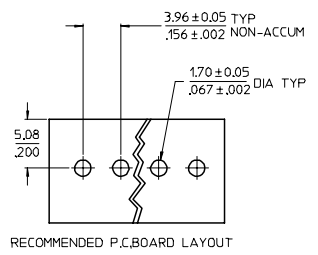

| | |
|-----|-----|
| 2-x | P6 |
| 1 | REV |

| | |
|---------------------|-------------|
| ADD P/N 26-62-4101 | 2006/05/18 |
| EC NO: UCF2006-2683 | 2006/05/18 |
| DRWN:ADERR | 2006/05/18 |
| CHKD:LSCHM1DT | 2006/05/18 |
| APPR:FSWJH | 2006/05/18 |
| REV | DESCRIPTION |
| P6 | |

| |
|-----------------|
| QUALITY SYMBOLS |
| ▽=0 |
| ▽=0 |

| GENERAL TOLERANCES (UNLESS SPECIFIED) | |
|--|---------------|
| | mm INCH |
| 4 PLACES | ± --- ± --- |
| 3 PLACES | ± --- ± .010 |
| 2 PLACES | ± 0.25 ± .015 |
| 1 PLACE | ± 0.38 ± --- |
| ANGULAR ±1/2° | |
| DRAFT WHERE APPLICABLE MUST REMAIN WITHIN DIMENSIONS | |

| DIMENSION STYLE | |
|-----------------|---|
| MM/IN | |
| DRAWN BY | DATE |
| JSCHAFFER | 11-07-03 |
| CHECKED BY | DATE |
| KSAMIEC | 11-10-03 |
| APPROVED BY | DATE |
| MARGULIS | 11-17-03 |
| MATERIAL NO. | DOCUMENT NO. |
| SEE CHART | SDA-41791 |
| SIZE B | THIS DRAWING CONTAINS INFORMATION THAT IS PROPRIETARY TO MOLEX INCORPORATED AND SHOULD NOT BE USED WITHOUT WRITTEN PERMISSION |

| | | |
|---|--------------|------------------------|
| SCALE | DESIGN UNITS | THIRD ANGLE PROJECTION |
| 2:1 | INCH | |
| TITLE | | |
| KK 156 HEADER ASSEMBLY FRICTION LOCK VERTICAL SOLID BODY W/O PEGS | | |
| MOLEX MOLEX INCORPORATED | | |
| SHEET NO. | | 1 OF * |

9 8 7 6 5 4 3 2 1

| | | | | | | | | |
|----------|--------------|-------------------|--------------|-------------------|--------------|-------------------|--------------|-----------------|
| OPTIONS | Group | A-41791-0002/0018 | Group | A-41791-0832/0848 | Group | A-41791-0849/0865 | Group | |
| | Header No: | 41790-0002/0018 | Header No: | 41790-0002/0018 | Header No: | 41790-0002/0018 | Header No: | |
| | Pin No: | 2161-94(102) | Pin No: | 43294-0209 | Pin No: | 43294-0210 | Pin No: | |
| | Plating: | 102 – TIN | Plating: | 208 – 15 GOLD | Plating: | 228 – 30 GOLD | Plating: | |
| | Pin Length L | 18.29 / .720 | Pin Length L | 18.29/. 720 | Pin Length L | 18.29/. 720 | Pin Length L | |
| | Mating M | 11.43 / .450 | Mating M | 11.43/. 450 | Mating M | 11.43/. 450 | Mating M | |
| | Gold Loc G | N/A | Gold Loc G | 6.86/. 270 | Gold Loc G | 6.86/. 270 | Gold Loc G | |
| | PC Tail P | 3.56 / .140 | PC Tail P | 3.56/. 140 | PC Tail P | 3.56/. 140 | PC Tail P | |
| | Tin Loc T | OVERALL | Tin Loc T | 4.06/. 160 | Tin Loc T | 4.06/. 160 | Tin Loc T | |
| | Voided Ckts | NONE | Voided Ckts | NONE | Voided CKts | NONE | Voided Ckts | |
| Pack Per | PK-41791-001 | Pack Per | PK-41791-001 | Pack Per | PK-41791-001 | Pack Per | | |
| | | | | | | | | |
| Ckts | Material No | Engineer Number | Material No | Engineer Number | Material No | Engineer Number | Material No | Engineer Number |
| 2 | 26-60-4020 | A-41791-0002 | 41791-0832 | A-41791-0832 | 41791-0849 | A-41791-0849 | | |
| 3 | 26-60-4030 | A-41791-0003 | 41791-0833 | A-41791-0833 | 41791-0850 | A-41791-0850 | | |
| 4 | 26-60-4040 | A-41791-0004 | 41791-0834 | A-41791-0834 | 41791-0851 | A-41791-0851 | | |
| 5 | 26-60-4050 | A-41791-0005 | 41791-0835 | A-41791-0835 | 41791-0852 | A-41791-0852 | | |
| 6 | 26-60-4060 | A-41791-0006 | 41791-0836 | A-41791-0836 | 41791-0853 | A-41791-0853 | | |
| 7 | 26-60-4070 | A-41791-0007 | 41791-0837 | A-41791-0837 | 41791-0854 | A-41791-0854 | | |
| 8 | 26-60-4080 | A-41791-0008 | 41791-0838 | A-41791-0838 | 41791-0855 | A-41791-0855 | | |
| 9 | 26-60-4090 | A-41791-0009 | 41791-0839 | A-41791-0839 | 41791-0856 | A-41791-0856 | | |
| 10 | 26-60-4100 | A-41791-0010 | 41791-0840 | A-41791-0840 | 41791-0857 | A-41791-0857 | | |
| 11 | 26-60-4110 | A-41791-0011 | 41791-0841 | A-41791-0841 | 41791-0858 | A-41791-0858 | | |
| 12 | 26-60-4120 | A-41791-0012 | 41791-0842 | A-41791-0842 | 41791-0859 | A-41791-0859 | | |
| 13 | 26-60-4130 | A-41791-0013 | 41791-0843 | A-41791-0843 | 41791-0860 | A-41791-0860 | | |
| 14 | 26-60-4140 | A-41791-0014 | 41791-0844 | A-41791-0844 | 41791-0861 | A-41791-0861 | | |
| 15 | 26-60-4150 | A-41791-0015 | 41791-0845 | A-41791-0845 | 41791-0862 | A-41791-0862 | | |
| 16 | 26-60-4160 | A-41791-0016 | 41791-0846 | A-41791-0846 | 41791-0863 | A-41791-0863 | | |
| 17 | 26-60-4170 | A-41791-0017 | 41791-0847 | A-41791-0847 | 41791-0864 | A-41791-0864 | | |
| 18 | 26-60-4180 | A-41791-0018 | 41791-0848 | A-41791-0848 | 41791-0865 | A-41791-0865 | | |

| | | | | | | | |
|-------------------|------|-----------------------------|--------|--|--------------|---------------|--|
| P6 | REV: | ECR/ECN INFORMATION | TITLE: | KK 156 HEADER ASSEMBLY FRICTION LOCK VERTICAL SOLID BODY W/O PEGS | SHEET No. | | |
| | | EC NO.: UCP2006-2683 | | | - 2 - | | |
| | | DATE: 5/18/2006 | | | | | |
| DOCUMENT NUMBER: | | CREATED / REVISED BY: | | CHECKED BY: | | APPROVED BY: | |
| SDA- 41791 | | ADERR | | LSCHMIDT | | FSMITH | |

| | | | | | | | | |
|----------|--------------|-------------------|--------------|-------------------|--------------|-------------------|--------------|-------------------|
| OPTIONS | Group | A-41791-0019/0035 | Group | A-41791-0036/0052 | Group | A-41791-0059/0074 | Group | A-41791-0086/0100 |
| | Header No: | 41790-0002/0018 | Header No: | 41790-0002/0018 | Header No: | 41790-0002/0018 | Header No: | 41790-0002/0018 |
| | Pin No: | 2161-94(501) | Pin No: | 2161-94(102) | Pin No: | 2161-94(102) | Pin No: | 2161-94(102) |
| | Plating: | 501 – GOLD | Plating: | 102 – TIN | Plating: | 102 – TIN | Plating: | 102 – TIN |
| | Pin Length L | 18.29 / .720 | Pin Length L | 18.29 / .720 | Pin Length L | 18.29 / .720 | Pin Length L | 18.29 / .720 |
| | Mating M | 11.43 / .450 | Mating M | 11.43 / .450 | Mating M | 11.43 / .450 | Mating M | 11.43 / .450 |
| | Gold Loc G | OVERALL | Gold Loc G | N/A | Gold Loc G | N/A | Gold Loc G | N/A |
| | PC Tail P | 3.56 / .140 | PC Tail P | 3.56 / .140 | PC Tail P | 3.56 / .140 | PC Tail P | 3.56 / .140 |
| | Tin Loc T | N/A | Tin Loc T | OVERALL | Tin Loc T | OVERALL | Tin Loc T | OVERALL |
| | Voided Ckts | NONE | Voided Ckts | 2 | Voided Ckts | 3 | Voided Ckts | 2, 4 |
| Pack Per | PK-41791-001 | Pack Per | PK-41791-001 | Pack Per | PK-41791-001 | Pack Per | PK-41791-001 | |
| | | | | | | | | |
| Ckts | Material No | Engineer Number | Material No | Engineer Number | Material No | Engineer Number | Material No | Engineer Number |
| 2 | 26-61-4020 | A-41791-0019 | 26-62-4020 | A-41791-0036 | | | | |
| 3 | 26-61-4030 | A-41791-0020 | 26-62-4030 | A-41791-0037 | 26-62-4036 | A-41791-0059 | | |
| 4 | 26-61-4040 | A-41791-0021 | 26-62-4040 | A-41791-0038 | 26-62-4046 | A-41791-0060 | 26-62-4041 | A-41791-0086 |
| 5 | 26-61-4050 | A-41791-0022 | 26-62-4050 | A-41791-0039 | 26-62-4056 | A-41791-0061 | 26-62-4051 | A-41791-0087 |
| 6 | 26-61-4060 | A-41791-0023 | 26-62-4060 | A-41791-0040 | 26-62-4066 | A-41791-0062 | 26-62-4061 | A-41791-0088 |
| 7 | 26-61-4070 | A-41791-0024 | 26-62-4070 | A-41791-0041 | 26-62-4076 | A-41791-0063 | | A-41791-0089 |
| 8 | 26-61-4080 | A-41791-0025 | 26-62-4080 | A-41791-0042 | 26-62-4086 | A-41791-0064 | | A-41791-0090 |
| 9 | 26-61-4090 | A-41791-0026 | 26-62-4090 | A-41791-0043 | 26-62-4096 | A-41791-0065 | | A-41791-0091 |
| 10 | 26-61-4100 | A-41791-0027 | 26-62-4100 | A-41791-0044 | 26-62-4106 | A-41791-0066 | 26-62-4101 | A-41791-0092 |
| 11 | 26-61-4110 | A-41791-0028 | 26-62-4110 | A-41791-0045 | 26-62-4116 | A-41791-0067 | | A-41791-0093 |
| 12 | 26-61-4120 | A-41791-0029 | 26-62-4120 | A-41791-0046 | 26-62-4126 | A-41791-0068 | | A-41791-0094 |
| 13 | 26-61-4130 | A-41791-0030 | 26-62-4130 | A-41791-0047 | 26-62-4136 | A-41791-0069 | | A-41791-0095 |
| 14 | 26-61-4140 | A-41791-0031 | 26-62-4140 | A-41791-0048 | 26-62-4146 | A-41791-0070 | | A-41791-0096 |
| 15 | 26-61-4150 | A-41791-0032 | 26-62-4150 | A-41791-0049 | 26-62-4156 | A-41791-0071 | | A-41791-0097 |
| 16 | 26-61-4160 | A-41791-0033 | 26-62-4160 | A-41791-0050 | 26-62-4166 | A-41791-0072 | | A-41791-0098 |
| 17 | 26-61-4170 | A-41791-0034 | 26-62-4170 | A-41791-0051 | 26-62-4176 | A-41791-0073 | | A-41791-0099 |
| 18 | 26-61-4180 | A-41791-0035 | 26-62-4180 | A-41791-0052 | 26-62-4186 | A-41791-0074 | | A-41791-0100 |

| | | | | | | | |
|-------------------|------|-----------------------------|--------|--|--------------|---------------|--|
| P6 | REV: | ECR/ECN INFORMATION | TITLE: | KK 156 HEADER ASSEMBLY FRICTION LOCK VERTICAL SOLID BODY W/O PEGS | SHEET No. | | |
| | | EC NO.: UCP2006-2683 | | | - 3 - | | |
| | | DATE: 5/18/2006 | | | | | |
| DOCUMENT NUMBER: | | CREATED / REVISED BY: | | CHECKED BY: | | APPROVED BY: | |
| SDA- 41791 | | ADERR | | LSCHMIDT | | FSMITH | |

| | | | | | | | | |
|----------|--------------|-------------------|--------------|-------------------|--------------|-----------------|--------------|-----------------|
| OPTIONS | Group | A-41791-0138/0154 | Group | A-41791-0253/0266 | Group | | Group | |
| | Header No: | 41790-0002/0018 | Header No: | 41790-0002/0018 | Header No: | | Header No: | |
| | Pin No: | 2161-94(122) | Pin No: | 2161-94(122) | Pin No: | | Pin No: | |
| | Plating: | 122 – TIN | Plating: | 122 – TIN | Plating: | | Plating: | |
| | Pin Length L | 18.29 / .720 | Pin Length L | 18.29 / .720 | Pin Length L | | Pin Length L | |
| | Mating M | 11.43 / .450 | Mating M | 11.43 / .450 | Mating M | | Mating M | |
| | Gold Loc G | N/A | Gold Loc G | N/A | Gold Loc G | | Gold Loc G | |
| | PC Tail P | 3.56 / .140 | PC Tail P | 3.56 / .140 | PC Tail P | | PC Tail P | |
| | Tin Loc T | OVERALL | Tin Loc T | OVERALL | Tin Loc T | | Tin Loc T | |
| | Voided Ckts | NONE | Voided Ckts | 5 | Voided Ckts | | Voided Ckts | |
| Pack Per | PK-41791-001 | Pack Per | PK-41791-001 | Pack Per | | Pack Per | | |
| Ckts | Material No | Engineer Number | Material No | Engineer Number | Material No | Engineer Number | Material No | Engineer Number |
| 2 | 26-60-4022 | A-41791-0138 | | | | | | |
| 3 | 26-60-4032 | A-41791-0139 | | | | | | |
| 4 | 26-60-4042 | A-41791-0140 | | | | | | |
| 5 | 26-60-4052 | A-41791-0141 | | A-41791-0253 | | | | |
| 6 | 26-60-4062 | A-41791-0142 | 26-62-4064 | A-41791-0254 | | | | |
| 7 | 26-60-4072 | A-41791-0143 | 26-62-4074 | A-41791-0255 | | | | |
| 8 | 26-60-4082 | A-41791-0144 | 26-62-4084 | A-41791-0256 | | | | |
| 9 | 26-60-4092 | A-41791-0145 | | A-41791-0257 | | | | |
| 10 | 26-60-4102 | A-41791-0146 | | A-41791-0258 | | | | |
| 11 | 26-60-4112 | A-41791-0147 | | A-41791-0259 | | | | |
| 12 | 26-60-4122 | A-41791-0148 | | A-41791-0260 | | | | |
| 13 | 26-60-4132 | A-41791-0149 | 26-62-4134 | A-41791-0261 | | | | |
| 14 | 26-60-4142 | A-41791-0150 | | A-41791-0262 | | | | |
| 15 | 26-60-4152 | A-41791-0151 | | A-41791-0263 | | | | |
| 16 | 26-60-4162 | A-41791-0152 | | A-41791-0264 | | | | |
| 17 | 26-60-4172 | A-41791-0153 | | A-41791-0265 | | | | |
| 18 | 26-60-4182 | A-41791-0154 | | A-41791-0266 | | | | |

| | | | | | | | |
|-------------------|------|-----------------------------|--------|--|--------------|---------------|--|
| P6 | REV: | ECR/ECN INFORMATION | TITLE: | KK 156 HEADER ASSEMBLY FRICTION LOCK VERTICAL SOLID BODY W/O PEGS | SHEET No. | | |
| | | EC NO.: UCP2006-2683 | | | - 4 - | | |
| | | DATE: 5/18/2006 | | | | | |
| DOCUMENT NUMBER: | | CREATED / REVISED BY: | | CHECKED BY: | | APPROVED BY: | |
| SDA- 41791 | | ADERR | | LSCHMIDT | | FSMITH | |

| | | | | | | | | |
|----------|--------------|-------------------|--------------|-------------------|--------------|-------------------|--------------|-----------------|
| OPTIONS | Group | A-41791-0297/0308 | Group | A-41791-0309/0308 | Group | A-41791-0464/0480 | Group | |
| | Header No: | 41790-0002/0018 | Header No: | 41790-0002/0018 | Header No: | 41790-0002/0018 | Header No: | |
| | Pin No: | 2161-94(122) | Pin No: | 2161-94(501) | Pin No: | 2161-1(102) | Pin No: | |
| | Plating: | 122 – TIN | Plating: | 501 – GOLD | Plating: | 102 – TIN | Plating: | |
| | Pin Length L | 18.29 / .720 | Pin Length L | 18.29 / .720 | Pin Length L | 19.05 / .750 | Pin Length L | |
| | Mating M | 11.43 / .450 | Mating M | 11.43 / .450 | Mating M | 11.43 / .450 | Mating M | |
| | Gold Loc G | N/A | Gold Loc G | OVERALL | Gold Loc G | N/A | Gold Loc G | |
| | PC Tail P | 3.56 / .140 | PC Tail P | 3.56 / .140 | PC Tail P | 4.32 / .170 | PC Tail P | |
| | Tin Loc T | OVERALL | Tin Loc T | N/A | Tin Loc T | OVERALL | Tin Loc T | |
| | Voided Ckts | 7 | Voided Ckts | 2 | Voided Ckts | NONE | Voided Ckts | |
| Pack Per | PK-41791-001 | Pack Per | PK-41791-001 | Pack Per | PK-41791-001 | Pack Per | | |
| Ckts | Material No | Engineer Number | Material No | Engineer Number | Material No | Engineer Number | Material No | Engineer Number |
| 2 | | | | | 26-60-4023 | A-41791-0464 | | |
| 3 | | | 26-63-4031 | A-41791-0310 | 26-60-4033 | A-41791-0465 | | |
| 4 | | | | A-41791-0311 | 26-60-4043 | A-41791-0466 | | |
| 5 | | | | A-41791-0312 | | A-41791-0467 | | |
| 6 | | | 26-63-4061 | A-41791-0313 | 26-60-4063 | A-41791-0468 | | |
| 7 | | A-41791-0297 | 26-63-4071 | A-41791-0314 | 26-60-4073 | A-41791-0469 | | |
| 8 | | A-41791-0298 | | A-41791-0315 | 26-60-4083 | A-41791-0470 | | |
| 9 | 26-60-4094 | A-41791-0299 | | A-41791-0316 | 26-60-4093 | A-41791-0471 | | |
| 10 | | A-41791-0300 | | A-41791-0317 | 26-60-4103 | A-41791-0472 | | |
| 11 | | A-41791-0301 | | A-41791-0318 | | A-41791-0473 | | |
| 12 | | A-41791-0302 | | A-41791-0319 | 26-60-4123 | A-41791-0474 | | |
| 13 | | A-41791-0303 | | A-41791-0320 | | A-41791-0475 | | |
| 14 | | A-41791-0304 | | A-41791-0321 | | A-41791-0476 | | |
| 15 | | A-41791-0305 | | A-41791-0322 | | A-41791-0477 | | |
| 16 | | A-41791-0306 | | A-41791-0323 | | A-41791-0478 | | |
| 17 | | A-41791-0307 | | A-41791-0324 | | A-41791-0479 | | |
| 18 | | A-41791-0308 | | A-41791-0325 | 26-60-4183 | A-41791-0480 | | |

| | | | | | |
|-------------------|------|-----------------------------|--------|--|---------------|
| P6 | REV: | ECR/ECN INFORMATION | TITLE: | KK 156 HEADER ASSEMBLY FRICTION LOCK VERTICAL SOLID BODY W/O PEGS | SHEET No. |
| | | EC NO.: UCP2006-2683 | | | - 5 - |
| DOCUMENT NUMBER: | | CREATED / REVISED BY: | | CHECKED BY: | APPROVED BY: |
| SDA- 41791 | | ADERR | | LSCHMIDT | FSMITH |

| | | | | | | | | |
|----------|--------------|-------------------|--------------|-------------------|--------------|-------------------|--------------|---------------------|
| OPTIONS | Group | A-41791-0583/0597 | Group | A-41791-0598/0609 | Group | A-41791-0638/0653 | Group | A-41791-1036 / 1048 |
| | Header No: | 41790-0002/0018 | Header No: | 41790-0002/0018 | Header No: | 41790-0002/0018 | Header No: | 41790-0006 / 0018 |
| | Pin No: | 2161-94(102) | Pin No: | 2161-94(102) | Pin No: | 2161-94(501) | Pin No: | 2161-94(102) |
| | Plating: | 102 – TIN | Plating: | 102 – TIN | Plating: | 501 – GOLD | Plating: | 102 – TIN |
| | Pin Length L | 18.29 / .720 | Pin Length L | 18.29 / .720 | Pin Length L | 18.29 / .720 | Pin Length L | 18.29 / .720 |
| | Mating M | 11.43 / .450 | Mating M | 11.43 / .450 | Mating M | 11.43 / .450 | Mating M | 11.43 / .450 |
| | Gold Loc G | N/A | Gold Loc G | N/A | Gold Loc G | OVERALL | Gold Loc G | N/A |
| | PC Tail P | 3.56 / .140 | PC Tail P | 3.56 / .140 | PC Tail P | 3.56 / .140 | PC Tail P | 3.56 / .140 |
| | Tin Loc T | OVERALL | Tin Loc T | OVERALL | Tin Loc T | N/A | Tin Loc T | OVERALL |
| | Voided Ckts | 4 | Voided Ckts | 7 | Voided Ckts | 3 | Voided Ckts | 4, 6 |
| Pack Per | PK-41791-001 | Pack Per | PK-41791-001 | Pack Per | PK-41791-001 | Pack Per | PK-41791-001 | |
| Ckts | Material No | Engineer Number | Material No | Engineer Number | Material No | Engineer Number | Material No | Engineer Number |
| 2 | | | | | | | | |
| 3 | | | | | | | | |
| 4 | 27-62-4049 | A-41791-0583 | | | | | | |
| 5 | 27-62-4059 | A-41791-0584 | | | | | | |
| 6 | 27-62-4069 | A-41791-0585 | | | 26-63-4032 | A-41791-0638 | | |
| 7 | 27-62-4079 | A-41791-0586 | 41791-0598 | A-41791-0598 | 41791-0639 | A-41791-0639 | | |
| 8 | 27-62-4089 | A-41791-0587 | 41791-0599 | A-41791-0599 | 26-63-4052 | A-41791-0640 | | |
| 9 | 27-62-4099 | A-41791-0588 | 41791-0600 | A-41791-0600 | 26-63-4062 | A-41791-0641 | | A-41791-1036 |
| 10 | 27-62-4109 | A-41791-0589 | 41791-0601 | A-41791-0601 | 41791-0642 | A-41791-0642 | 41791-1037 | A-41791-1037 |
| 11 | 27-62-4119 | A-41791-0590 | 41791-0602 | A-41791-0602 | 26-63-4082 | A-41791-0643 | | A-41791-1038 |
| 12 | 27-62-4129 | A-41791-0591 | 41791-0603 | A-41791-0603 | 41791-0644 | A-41791-0644 | | A-41791-1039 |
| 13 | 27-62-4139 | A-41791-0592 | 41791-0604 | A-41791-0604 | 41791-0645 | A-41791-0645 | | A-41791-1040 |
| 14 | 27-62-4149 | A-41791-0593 | 41791-0605 | A-41791-0605 | 41791-0646 | A-41791-0646 | | A-41791-1041 |
| 15 | 27-62-4159 | A-41791-0594 | 41791-0606 | A-41791-0606 | 41791-0647 | A-41791-0647 | | A-41791-1042 |
| 16 | 27-62-4169 | A-41791-0595 | 41791-0607 | A-41791-0607 | 41791-0648 | A-41791-0648 | | A-41791-1043 |
| 17 | 27-62-4179 | A-41791-0596 | 41791-0608 | A-41791-0608 | 41791-0649 | A-41791-0649 | | A-41791-1044 |
| 18 | 27-62-4189 | A-41791-0597 | 41791-0609 | A-41791-0609 | 41791-0650 | A-41791-0650 | | A-41791-1045 |
| | | | | | 41791-0651 | A-41791-0651 | | A-41791-1046 |
| | | | | | 41791-0652 | A-41791-0652 | | A-41791-1047 |
| | | | | | 41791-0653 | A-41791-0653 | | A-41791-1048 |

| | | | | | |
|-------------------|------|-----------------------------|---------------|--|--------------|
| P6 | REV: | ECR/ECN INFORMATION | TITLE: | KK 156 HEADER ASSEMBLY FRICTION LOCK VERTICAL SOLID BODY W/O PEGS | SHEET No. |
| | | EC NO.: UCP2006-2683 | | | - 6 - |
| | | DATE: 5/18/2006 | | | |
| DOCUMENT NUMBER: | | CREATED / REVISED BY: | | CHECKED BY: | |
| SDA- 41791 | | ADERR | | LSCHMIDT | |
| | | | APPROVED BY: | | |
| | | | FSMITH | | |

| | | | | | | | | |
|----------|--------------|-------------------|--------------|-------------------|--------------|-------------------|--------------|-------------------|
| OPTIONS | Group | A-41791-0815/0831 | Group | A-41791-0883/0891 | Group | A-41791-0892/0908 | Group | A-41791-0922/0933 |
| | Header No: | 41790-0002/0018 | Header No: | 41790-0010/0018 | Header No: | 41790-0002/0018 | Header No: | 41790-0007/0018 |
| | Pin No: | 2161-36(102) | Pin No: | 2161-94(102) | Pin No: | 43294-0299 | Pin No: | 2161-94(102) |
| | Plating: | 102 – TIN | Plating: | 102 – TIN | Plating: | 208 – 15 GOLD | Plating: | 102 – TIN |
| | Pin Length L | 30.48 / 1.200 | Pin Length L | 18.29 / .720 | Pin Length L | 20.83 / .820 | Pin Length L | 18.29 / .720 |
| | Mating M | 11.43 / .450 | Mating M | 11.43 / .450 | Mating M | 11.43 / .450 | Mating M | 11.43 / .450 |
| | Gold Loc G | N/A | Gold Loc G | N/A | Gold Loc G | 6.83/. 270 | Gold Loc G | N/A |
| | PC Tail P | 15.75/ .620 | PC Tail P | 3.56 / .140 | PC Tail P | 6.10/ .240 | PC Tail P | 3.56 / .140 |
| | Tin Loc T | OVERALL | Tin Loc T | OVERALL | Tin Loc T | 6.35/ .250 | Tin Loc T | OVERALL |
| | Voided Ckts | NONE | Voided Ckts | 10 | Voided Ckts | NONE | Voided Ckts | 5, 7 |
| Pack Per | PK-41791-003 | Pack Per | PK-41791-001 | Pack Per | PK-41791-002 | Pack Per | PK-41791-001 | |
| Ckts | Item Number | Item Number | Item Number | Item Number | Item Number | Item Number | Item Number | |
| 2 | 41791-0815 | | | 41791-0892 | | | | |
| 3 | 41791-0816 | | | 41791-0893 | | | | |
| 4 | 41791-0817 | | | 41791-0894 | | | | |
| 5 | 41791-0818 | | | 41791-0895 | | | | |
| 6 | 41791-0819 | | | 41791-0896 | | | | |
| 7 | 41791-0820 | | | 41791-0897 | | 41791-0922 | | |
| 8 | 41791-0821 | | | 41791-0898 | | 41791-0923 | | |
| 9 | 41791-0822 | | | 41791-0899 | | 41791-0924 | | |
| 10 | 41791-0823 | 41791-0883 | | 41791-0900 | | 41791-0925 | | |
| 11 | 41791-0824 | 41791-0884 | | 41791-0901 | | 41791-0926 | | |
| 12 | 41791-0825 | 41791-0885 | | 41791-0902 | | 41791-0927 | | |
| 13 | 41791-0826 | 41791-0886 | | 41791-0903 | | 41791-0928 | | |
| 14 | 41791-0827 | 41791-0887 | | 41791-0904 | | 41791-0929 | | |
| 15 | 41791-0828 | 41791-0888 | | 41791-0905 | | 41791-0930 | | |
| 16 | 41791-0829 | 41791-0889 | | 41791-0906 | | 41791-0931 | | |
| 17 | 41791-0830 | 41791-0890 | | 41791-0907 | | 41791-0932 | | |
| 18 | 41791-0831 | 41791-0891 | | 41791-0908 | | 41791-0933 | | |

| | | | |
|-----------|-----------------------------|--|--------------|
| REV: | ECR/ECN INFORMATION | TITLE: | SHEET No. |
| P6 | EC NO.: UCP2006-2683 | KK 156 HEADER ASSEMBLY FRICTION LOCK VERTICAL SOLID BODY W/O PEGS | - 7 - |
| | DATE: 5/18/2006 | | |
| | DOCUMENT NUMBER: SDA- 41791 | | |

| | | | | | | | | |
|----------|--------------|-----------------|--------------|-----------------|--------------|-----------------|--------------|-------------------|
| OPTIONS | Group | 41791-0934/0948 | Group | 41791-0966/0976 | Group | 41791-0977/0993 | Group | 41791-0994/1002 |
| | Header No: | 41790-0004/0018 | Header No: | 41790-0007/0018 | Header No: | 41790-0002/0018 | Header No: | 41790-0010/0018 |
| | Pin No: | 43294-0209 | Pin No: | 2161-94(102) | Pin No: | 43294-0345 | Pin No: | 43294-0209 |
| | Plating: | 208 – 15 GOLD | Plating: | 102 – TIN | Plating: | 228 – 30 GOLD | Plating: | 208 – 15 GOLD |
| | Pin Length L | 18.29/. 720 | Pin Length L | 18.29/. 720 | Pin Length L | 22.10/. 870 | Pin Length L | 18.29/. 720 |
| | Mating M | 11.43 / .450 | Mating M | 11.43/. 450 | Mating M | 11.43/. 450 | Mating M | 11.43 / .450 |
| | Gold Loc G | 6.86/ .270 | Gold Loc G | N/A | Gold Loc G | 10.02/. 400 | Gold Loc G | 6.86/ .270 |
| | PC Tail P | 3.56/. 140 | PC Tail P | 3.56/. 140 | PC Tail P | 7.37/. 290 | PC Tail P | 3.56/. 140 |
| | Tin Loc T | 4.06/. 160 | Tin Loc T | OVERALL | Tin Loc T | 5.08/. 200 | Tin Loc T | 4.06/. 160 |
| | Voided Ckts | 4 | Voided Ckts | 3, 7, 8 | Voided Ckts | None | Voided Ckts | 3, 4, 5, 8, 9, 10 |
| Pack Per | PK-41791-001 | Pack Per | PK-41791-001 | Pack Per | PK-41791-002 | Pack Per | PK-41791-001 | |
| Ckts | Item Number | | Item Number | | Item Number | | Item Number | |
| 2 | | | | | 41791-0977 | | | |
| 3 | | | | | 41791-0978 | | | |
| 4 | 41791-0934 | | | | 41791-0979 | | | |
| 5 | 41791-0935 | | | | 41791-0980 | | | |
| 6 | 41791-0936 | | | | 41791-0981 | | | |
| 7 | 41791-0937 | | | | 41791-0982 | | | |
| 8 | 41791-0938 | | 41791-0966 | | 41791-0983 | | | |
| 9 | 41791-0939 | | 41791-0967 | | 41791-0984 | | | |
| 10 | 41791-0940 | | 41791-0968 | | 41791-0985 | | 41791-0994 | |
| 11 | 41791-0941 | | 41791-0969 | | 41791-0986 | | 41791-0995 | |
| 12 | 41791-0942 | | 41791-0970 | | 41791-0987 | | 41791-0996 | |
| 13 | 41791-0943 | | 41791-0971 | | 41791-0988 | | 41791-0997 | |
| 14 | 41791-0944 | | 41791-0972 | | 41791-0989 | | 41791-0998 | |
| 15 | 41791-0945 | | 41791-0973 | | 41791-0990 | | 41791-0999 | |
| 16 | 41791-0946 | | 41791-0974 | | 41791-0991 | | 41791-1000 | |
| 17 | 41791-0947 | | 41791-0975 | | 41791-0992 | | 41791-1001 | |
| 18 | 41791-0948 | | 41791-0976 | | 41791-0993 | | 41791-1002 | |

| | | | | | | | |
|-------------------|------|-----------------------|--------|--|--------------|---------------|--|
| P6 | REV: | ECR/ECN INFORMATION | TITLE: | KK 156 HEADER ASSEMBLY FRICTION LOCK VERTICAL SOLID BODY W/O PEGS | SHEET No. | | |
| | | EC NO.: UCP2006-2683 | | | - 8 - | | |
| | | DATE: 5/18/2006 | | | | | |
| DOCUMENT NUMBER: | | CREATED / REVISED BY: | | CHECKED BY: | | APPROVED BY: | |
| SDA- 41791 | | ADERR | | LSCHMIDT | | FSMITH | |

| | | | | | | | | |
|----------|--------------|-------------------|--------------|-------------------|--------------|-------------------|--------------|-------------------|
| OPTIONS | Group | A-41791-1049/1062 | Group | A-41791-1063/1071 | Group | A-41791-1074/1088 | Group | A-41791-0773/0785 |
| | Header No: | 41790-0005/0018 | Header No: | 41790-0010/0018 | Header No: | 41790-0004/0018 | Header No: | 41790-0006/0018 |
| | Pin No: | 2161-94(102) | Pin No: | 2161-94(102) | Pin No: | 2161-94(501) | Pin No: | 2161-94(102) |
| | Plating: | 102 – TIN | Plating: | 102 – TIN | Plating: | 501 – GOLD | Plating: | 102-TIN |
| | Pin Length L | 18.29 / .720 | Pin Length L | 18.29 / .720 | Pin Length L | 18.29 / .720 | Pin Length L | 18.29/.720 |
| | Mating M | 11.43 / .450 | Mating M | 11.43 / .450 | Mating M | 11.43 / .450 | Mating M | 11.43/.450 |
| | Gold Loc G | N/A | Gold Loc G | N/A | Gold Loc G | OVERALL | Gold Loc G | N/A |
| | PC Tail P | 3.56 / .140 | PC Tail P | 3.56 / .140 | PC Tail P | 3.56 / .140 | PC Tail P | 3.56/.140 |
| | Tin Loc T | OVERALL | Tin Loc T | OVERALL | Tin Loc T | N/A | Tin Loc T | OVERALL |
| | Voided Ckts | 2, 5 | Voided Ckts | 5, 10 | Voided Ckts | 2, 3, 4 | Voided Ckts | 3, 6 |
| Pack Per | PK-41791-001 | Pack Per | PK-41791-001 | Pack Per | PK-41791-001 | Pack Per | PK-41791-001 | |
| Ckts | Item Number | | Item Number | | Item Number | | Item Number | |
| 2 | | | | | | | | |
| 3 | | | | | | | | |
| 4 | | | | | | | | |
| 5 | | | | | 41791-1075 | | | |
| 6 | | | | | | | | |
| 7 | 41791-1051 | | | | | | 41791-0774 | |
| 8 | | | | | | | | |
| 9 | | | | | | | | |
| 10 | | | | | | | | |
| 11 | | | 41791-1064 | | | | | |
| 12 | | | | | | | | |
| 13 | | | | | | | | |
| 14 | | | | | | | | |
| 15 | | | | | | | | |
| 16 | | | | | | | | |
| 17 | | | | | | | | |
| 18 | | | | | | | | |

| | | | | | |
|-------------------|------|-----------------------|--------|--|--------------|
| P6 | REV: | ECR/ECN INFORMATION | TITLE: | KK 156 HEADER ASSEMBLY FRICTION LOCK VERTICAL SOLID BODY W/O PEGS | SHEET No. |
| | | EC NO.: UCP2006-2683 | | | - 9 - |
| | | DATE: 5/18/2006 | | | |
| DOCUMENT NUMBER: | | CREATED / REVISED BY: | | CHECKED BY: | |
| SDA- 41791 | | ADERR | | LSCHMIDT | |
| | | | | APPROVED BY: FSMITH | |